

AMERICAN-CANADIAN GENEALOGICAL SOCIETY
MEETING OF BOARD OF DIRECTORS
DECEMBER 10, 1998

Call to Order

President Al Hamel opened the meeting at 6:31 p.m. A quorum was present.

Roll Call

Present:

President Al Hamel
Vice President Roland Marchand
Treasurer Gerry Lalond
Director Craig Donais
Librarian Mary Jean Chaput
Director Charles Martel
Director Sam Harris
Assistant Librarian Pauly Labbe
Director Bob Maurier
Director Anne-Marie Perrault
Recording Secretary Carol A. Belmain
Research Department - Constance Hebert
Mary Anna Paquette, Corresponding Secretary

Roger Lawrence, Honorary President was absent

Recording Secretary's Report

The minutes of the November 12, 1998, meeting were presented by the recording secretary.

Changes requested: The attendance roster should indicate that Mary-Anna Paquette's record should be changed from absent to excused.

In the future, the attendance roster and the minutes should reflect Mary Jean Colburn as Mary Jean Chaput .

Craig Donais made a motion to accept the minutes as corrected. Robert Maurier seconded the motion. Motion carried.

Treasurer's Report - Gerry Lalond

Mr. Lalond presented his written report. See attached report. Craig Donais requested an explanation of item 4.9 Other. Mr. Lalond explained that the \$100 item represented a donation in memory of Amos Fairfield. Mr. Lalond indicated that he had spoken with Mrs. Fairfield and they were discussing what kind of leaf to add to the memorial tree. Mrs. Fairfield has deferred to the board's choice of a leaf. It was decided that a gold leaf would be added in Amos' memory. Mr. Lalond indicated that approximately \$800. had been donated and that he had yet to donate, but would make up the difference. A discussion ensued in that Mr. Lalond need not be the only one to make up the difference of the cost of the leaf and that the Association would also help in this matter.

A draft budget was offered for consideration, comments, and suggestions. Mr. Lalond and President Hamel asked that everyone review the budget and make suggestions and recommendations at the next meeting. The membership drive synopsis which was offered as part of the budget for review is considered very important.

President Hamel indicated that a check for \$150. which had been given to Walter Hickey, speaker at the Conference, who works for the Archives, had been refused due to Mr. Hickey's employment status. Since the check was returned, it was suggested that a contribution to the Friends of the Archives in the area be made. Mr. Robert Maurier made a motion to donate the \$150. to the Friends of the Archives. Mary Jean Chaput seconded the motion. The motion carried.

Vice-President's Report - Roland Marchand

No report presented.

President's Report - Al Hamel

President Hamel reported that Bob Quintin claims to have exclusive rights to sell Jette and inquired whether the Association should challenge him on this issue. A discussion determined that we should not challenge Mr. Quintin. It was decided that if we continue to offer specialized material for sale, we should look for a new display area to accommodate the display of those items for sale.

Corresponding Secretary - Mary Anna Paquette

A written report was presented. See attached report. Ms. Paquette indicated that it had been a slower month, but not by much compared to the previous month. Mary Jean Chaput made a motion to accept the report as presented. Mr. Lalond seconded. The motion carried.

COMMITTEE REPORTS

Acquisitions - Robert Maurier

Mr. Maurier reported that there were new acquisitions in progress. He indicated that he would be writing to Mr. Pepin, AFGS regarding the many collections.

President Al Hamel presented vital statistics from Somersworth and Rollinsford, New Hampshire and Berwick, Maine for review to see whether the Acquisitions Committee would be interested in meeting with the author Philip Lessard, a member, to see whether a working relationship could be devised regarding the publication and sale of the books. Mr. Robert Maurier and Pauline Cote should be contacted in this matter.

Buildings & Grounds

President Hamel indicated that he had received a letter from the pastor of the church regarding the plowing of the parking lot. Mr. Hamel indicated that he would deal with the plowing issue.

Shading for the windows was discussed and it was recommended that Mr. Lalond have someone come in to install the material to just certain windows. After review of the effects of this shading, a decision will be made whether the 81% light diffusion is effective. The cost per window is \$27 and there are 20 windows to which the material would be adhered.

A motion was made by Anne-Marie Perrault that one window should be coated. Craig Donais seconded the motion. Mr. Charles Martel requested to amend the motion to have a window on each the south and the north side coated. The motion carried as amended.

The need for air conditioners was discussed and it was suggested that four units should be installed. The placement of the units was discussed. It was suggested that more information retrieved and more discussion should occur before the next board meeting. Mr. Lalond is to get more information.

Anne-Marie Perrault suggested the need for screens for the third floor windows. Mary Jean Chaput personally thanked the president for making sure that locks were installed in the facilities area.

Mr. Lalond indicated that a 10' table had been moved into the premises, and that a decision should be made as to placement.

Public Address System - Roland Marchand

Mr. Marchand indicated that there was a revised proposal for the implementation of a public address system which had changes from the original proposal. He indicated that there would be one remote mike and one lapel mike - Mr. Lalond also reported that prices for the items had been reduced from the original estimates. The specifications of the proposed system were discussed, and it was indicated that the system was expandable in the future.

Mr. Marchand made a motion to accept the public address proposal as amended, not to exceed the cost of \$1,001. The motion was seconded by Mr. Lalond. The motion carried. See revised proposal attached.

Computers - Roland Marchand

A written report was presented. See attached report. It was reported that the PRDH software has not arrived as yet. It was explained that the initial software version would be in French. The English version would arrive in January 1999. It will be necessary to review the PRDH's installation because of the disk capacity.

The replacement of a certain monitor was discussed, since the monitor is flickering.

Conferences

Anne Marie asked whether a spring workshop would be scheduled. It was the general consensus that a workshop should be organized to include the introduction and explanation on how to use Parchemin, how to use the computers, and general instructions on how to begin a personal search. A planning meeting for the mini conference was scheduled for January 4, 1999, at 6:00 p.m.

President Hamel indicated that there would be a New England Regional Genealogical Conference on May 31 through June 3, 2000. It is sponsored by the National Genealogical Society and we should consider participating in order to have more exposure. He suggested that there should be some monthly/planning meetings organized if the Society plans to participate.

President Hamel also indicated that there would be a conference in May 1999, New Hampshire Library Association, and we have been invited to attend. He has been asked to speak generally about the web.

Editorial - Anne-Marie Perrault

A written report was presented. See attached report. Ms. Perrault's reported the discussion on orphan publications for which the Board of Directors has made the responsibility of the Editorial Board. She also opened for discussion the moving of the

President's Page and Editor's page to the colored sheet inserts which are included in the Genealogist. It was agreed that the inserts were timely items of value which added to the historical value of the publication.

Library - Mary Jean Chaput

A written report was presented. See attached report. A discussion about the extended hours and the need for more volunteers was brought up.

Membership - Judy Arsenault

No report presented.

Publicity

Mr. Sam Harris asked whether Association fliers could be distributed at his work place. A general discussion regarding publicity ensued and it was determined that generic association cards and trifold would be made available to anyone in order for the Association to become better known.

Anne Marie-Perrault indicated that cards should be ordered since the last supply has been used up. It was agreed that the generic card would include a map on the back of the card.

It was also indicated that the Office of Tourism would include the Association's trifold in their collection.

Publications - Pauline G. Cote

No report presented.

Research - Constance Hebert

A written report was presented by Constance Hebert. See attached report. Ms. Hamel reported that it had been a slow month. She estimated that the Parchemin income was at approximately \$600. since installation. Since the anniversary of the installation of Parchemin is coming up, Mr. Lalond suggested that it should be guaranteed for another year for evaluation since we are the only library to offer the service.

Internet - President Al Hamel

It was reported that Mr. Hamel had spoken with Ron Niquette and would be having a meeting with him regarding the web page. The President indicated that there was a need for someone to do the updates to the web and for E-mail to be processed.

The President invited members to attend a meeting on Friday, December 18, 1998, after 6:00 p.m. for those who wanted to discuss the web page set up.

Inventory - Gerry Lalond

Mr. Lalond reported that the inventory was in process.

Obituary Report

No report presented.

Old Business:

President Hamel discussed the need to comply with the Attorney General's letter requesting a policy for conflict of interest by board members. He explained that he had reached Pauline Cusson regarding her concerns and that issue had been resolved. A form for all board members to sign was presented. All members but Charles Martel signed the form.

The President requested that Carol Belmain prepare the letters for transmittal of the signed forms to the Attorney General, together with the minutes of the November meeting and the names and addresses of the board members who signed the policy statement. Mr. Martel's name will be included as not having signed the form.

New Business: - Al Hamel

See Conferences.

The next board meeting is scheduled for Monday, January 11, 1999, at 6:30 p.m.

Adjournment

The meeting adjourned at 8:40 p.m.

Respectfully submitted,

Carol A. Belmain

Carol A. Belmain

Recording Secretary

Car.

AMERICAN CANADIAN GENEALOGICAL SOCIETY
OCTOBER 1998 THROUGH SEPTEMBER 1999

ROLL CALL

(P = PRESENT, E = EXCUSED, A = ABSENT)

[illegible]

ACGS BOARD MEETINGS 1998-1999 (Oct. 98-Sep 99)

Date:	Motion subject:	Moved by:	Seconded by:	Result
11/12/98	Network system implementation	Mary-Jean Colburn	Craig Donais	Carried
11/12/98	Expand Editorial Board	Anne-Marie Perrault	Mary-Jean Colburn	Carried
11/12/98	Bulletin Board	Anne-Marie Perrault	Charles Martel	Carried
11/12/98	Conflict of Interest Policy	Craig Donais	Anne-Marie Perrault	Carried
12/10/98	Accept recording secretary's report	Craig Donais	Robert Maurier	Carried with corrections
12/10/98	Donation of \$150 to Friends of the Archives	Robert Maurier	Mary Jean Chaput	Carried
12/10/98	Accept corresponding secretary's report	Mary Jean Chaput	Gerald Lalond	Carried
12/10/98	Window shading	Anne-Marie Perrault	Craig Donais	Carried as amended
12/10/98	Public address system	Roland Marchand	Gerald Lalond	Carried

ACGS
MEETING OF THE BOARD OF DIRECTORS
10 December 1998

✓ CALL TO ORDER

✓ ROLL CALL

✓ RECORDING SECRETARY (MINUTES)

✓ TREASURER'S REPORT (Gerry L.)

✓ VICE-PRESIDENT (Roland M.)

PRESIDENT

✓ CORRESPONDING (MAP)
SECRETARY

**COMMITTEE
REPORTS**

- ✓ Acquisitions: (Bob M.)
- ✓ Buildings & Grounds (.)
- ✓ Computers (Roland M)
- ✓ Conferences
- ✓ Editorial (AMP) see report
- ✓ LIBRARY (MJC) see report
- ✓ MEMBERSHIP
- ✓ PUBLICITY -
- ✓ PUBLICATIONS See report
- ✓ RESEARCH (Constance H.) See report
- ✓ INTERNET
- INVENTORY
- OBITUARY REPORT

OLD BUSINESS Conflict of Interest issue

NEW BUSINESS (Smithsonian); (Festival de l'ete indien)

ADJOURNMENT

Next meeting: 1800 hours, 10 Dec 1998



PLEASE NOTE



December 3, 1998

TO: Volunteers

FROM: Library Board

BOOKS – "Main Collection"

The re-numbering of the "Main Collection" is nearing completion. There are about 100-150 left to change out of the total of 900* books. The card files are being updated at the same time – both by subject and by author. We have tried very diligently to be sure these are correct, however it is impossible to be perfect – even for us! If you find a number, or card, that needs to be changed/corrected please leave a note in the box for Mary Anna Paquette. Keep in mind that even if a file card may be missing, the research database will have the most up-to-date info. Check the computer before you start complaining that you can't find a book!

Copies of the summary of the Library of Congress Classification System, as it applies to the categories in our library, are attached. We hope you find this useful and thank you for your patience during this time.

Thank you.

ACGS Library Volunteers – as of 12/3/1998

NAME	PHONE	TIME PREFERENCE
Beland, Amber		
Belmain, Carol	483-8479	
Boucher, Bryan	434-0117	
Boucher, Sylvia	888-3368	
Bussiere, Russ	508-342-4391	Friday evenings
Chase, Claire	668-1880	
Colburn, Mary Jean	432-8659	Wed/Fri evening, Sat morning
Cusson, Pauline	647-6521	
Daley, Eileen	978-851-7841	Any time
Deschenes, Lorraine	366-2661	Wednesdays & Saturdays
Desmarais, Annette	978-454-8453	
Donais, Craig	(h) 978-256-8370	(w) 603-271-2646
Fairfield, Barbara	642-5687	
Fortin, Richard	641-3450	Afternoons only 2:00-4:45
Hamel, Al & Connie	887-3154	Any time except 3rd Fridays
Harris, Sam	679-4663	
Hebert, Constance G.	622-4250	Wed 10-2PM; Fri 6-9PM
Labbe, Pauly	622-5493	
Lancot, Roger P.	487-2550	
Lawrence, Roger	424-2332	
Lozier, Diane		
Marchand, Roland	882-7339	
Martel, L. Charles	(h) 647-4527	(w) 669-3614
Melbourne, Michael		
Morency, Jerry & Lucie	888-6679	Saturdays only
Neveux, Robert	634-4311	
Paquette, Mary Anna	483-5457	
Paquette, Robert	483-2791	
Roy, Claire	624-1213	
Smith, Julie	625-8753	
St Laurent, Jeanette	772-5583	
Stanton, Jack	623-4743	
Swenson, Lynne	889-2804	Friday evening or Sat. afternoon
Wise, Lillian	228-2135	

(Count: 35)

If you are unable to be at the library for the time for which you signed up, call another volunteer from the above list to take your place. ALSO, call Connie Hamel 887-3154 and let her know about the change.



ACGS Volunteer Schedule for the month of:
December 1998



Sunday	Monday	Tuesday	Wednesday	Thursday	Friday	Saturday
		1	2 9-12 - Barbara Fairfield 12-3 - Jeannette St Laurent 3-6 - Lorraine Deschenes 6-9 - Al & Connie Hamel	3	4 9-12 - Michael Malbourne 12-3 - Pauly Labbe 3-6 - Constance Hebert 6-9 - ??	5 9-12:30 - Jerry Morency Lucie Morency 12:30-4 - Jerry & Lucie
6	7	8	9 9-12 - Bob Neveux 12-3 - Jeannette St Laurent 3-6 - Lorraine Deschenes 6-9 - ??	10	11 9-12 - Sylvia Boucher 12-3 - ?? 3-6 - Constance Hebert 6-9 - ??	12 9-12:30 - Claire Chase 12:30-4 - Bryan Boucher Amber Beland
13	14	15	16 9-12 - Jack Stanton 12-3 - Pauly Labbe 3-6 - Lorraine Deschenes 6-9 - Craig Donais	17	18 9-12 - Michael Malbourne 12-3 - Pauly Labbe 3-6 - Constance Hebert 6-9 - Diane Lozier	19 9-12:30 - ?? 12:30-4 - Lynne Swenson
20	21	22	23 9-12 - Barbara Fairfield 12-3 - ?? 3-6 - Lorraine Deschenes 6-9 - Pauline Cusson	24	25  Christmas	26 9-12:30 - Mary Jean Chaput 12:30-4 - ??
27	28	29	30 9-12 - Bob Neveux 12-3 - Mary Jean Chaput 3-6 - ?? 6-9 - Carol Belmain	31 New Year's Eve		

Merry Christmas - Joyeux Noel!!.....

The Library of Congress Classification System

The Library of Congress Classification System separates all knowledge into 21 classes. Each class is identified by a letter of the alphabet, subclasses by combinations of letters, and subtopics within classes and subclasses by a numerical notation.

The following is a condensed version of the Classification System using mainly only those codes which apply to the books in the ACGS Library.

Classes	Classes
A General Works	H Social Sciences HM-HX Sociology
B Philosophy – Religion/Church BL-BX Histories in US and Canada, including clergy	J Political Science – Emigration/Immigration
C Auxiliary Sciences of History CS Genealogy (General Collections) CT Biography (General)	K Law
D History: General and Old World (including geography of individual countries) D World history, including World Wars DA Great Britain DC France	L Education
E-F History of America (including geography of individual countries) E1-143 America (General – includes North and South) E151-857 United States (General) F1-957 United States: States and local F1001-1140 Canada, including Acadia, New Brunswick and Prince Edward Island F1201, etc Other individual countries	M Music
G Geography, Anthropology, Folklore, etc GR Folklore	N Fine Arts
	P Language and Fiction PC Romance Languages PQ French or Canadian literature (fiction) PR English Literature (fiction) PS American Literature (fiction)
	Q Science
	R Medicine
	S Agriculture
	T Technology
	U Military Science
	V Naval Science
	Z Bibliography and Library Science

The call numbers on each book are a combination of alphanumeric as follows -

First line: The first letter(s) identifies the class or the most general category to which the subject of the book relates.

Second line: The first number(s) are a subdivision of that general category

Third line: A further subdivision that stands for something specific, such as a person, town, church, event.

Subsequent lines may provide further specific information. See examples below:

Calloway, Colin G.

"The Western Abenakis of Vermont, 1600-1800; war, migration and the survival of an Indian People" by Colin G. Calloway

This is the call number, with explanation:

E	History of America
99	General
.A13	Abenakis (specific subject)
C36	Calloway (the author)

Smith, Olive Willett

"Gaspé, the romantique" by Olive Willett Smith

F	History of America
1054	Canada
.G2	Gaspé
S6	Smith

and right next to it we find

Hogner, Dorothy Childs

"Summer Roads to Gaspé" by Dorothy Childs Hogner

F	History of America
1054	Canada
.G2	Gaspé
H716	Hogner

When looking for a book, you must read the call number of general category first. The books are arranged on the shelves in the history section in alphabetical order. If you are looking for "Gaspé, the romantique" you will take these steps to find it.

The call number is

F
1054
.G2
S6

1. Look for the F. Once you have found it, go to the 2nd line of the call number 1054.
2. The lowest number in the F section is 1. Follow the numbers on the spine of each book going from left to right until you get to the number 1054.
3. Follow the alphanumeric line until you get to the .G2. All of these books will be about Gaspé. Go down one more line to find the exact title you are looking for.
4. The 4th line is also alphanumeric and stands for the author. Go to the last line and follow it across each book until you reach S6.

12/03/98

AMERICAN-CANADIAN GENEALOGICAL SOCIETY INCOME & EXPENSE

November 1998

	Nov '98	Jan - Nov '98
Income		
1.0 MEMBERSHIP		
1.1 Dues	5,254.00	55,953.00
Total 1.0 MEMBERSHIP	5,254.00	55,953.00
2.0 PUBLICATIONS		
2.3 Repertoires	813.10	8,282.20
2.4 Index & Holdings	0.00	343.00
2.5 Jette	960.00	5,260.00
2.6 Video S. R.	0.00	10.00
2.7 Border Crossings	0.00	40.00
Total 2.0 PUBLICATIONS	1,773.10	13,935.20
3.0 GENEALOGIST		
3.1 Back Issues	10.50	688.80
3.2 Advertising	0.00	100.00
Total 3.0 GENEALOGIST	10.50	788.80
4.0 LIBRARY		
4.1 All Copies	594.63	3,366.18
4.2 Maps-Charts-Guides	246.60	2,524.64
4.3 Guest Fees	85.00	2,075.00
4.5 Beverages	91.00	870.45
4.6 Candy/Snacks	103.62	695.40
4.7 Hats	0.00	76.00
4.8 Gift Certificates	0.00	25.00
4.9 Other	100.00	773.50
Total 4.0 LIBRARY	1,220.85	10,406.17
5.0 RESEARCH		
5.1 RS Income	324.00	3,800.60
5.2 Parchemin	28.00	525.00
Total 5.0 RESEARCH	352.00	4,325.60
6.0 CONFERENCE		
6.1 Attend Fees	0.00	14,272.00
6.4 Vendor Booth	0.00	500.00
6.5 Advertising	0.00	1,610.00
Total 6.0 CONFERENCE	0.00	16,382.00
7.0 SOCIETY		
7.2 Bldg Fund	145.00	3,996.77
7.3 Book Fund	180.00	1,236.00
7.6 Ckg Act Int	7.06	121.04
7.7 Bld Fnd Int	0.44	120.25
7.8 Sav Act Int	1.58	16.46
7.9 Other	-2.10	1,872.02
Total 7.0 SOCIETY	331.98	7,362.54
8.0 BUILDING		
8.1 Rental Inc	1,750.00	16,625.00
Total 8.0 BUILDING	1,750.00	16,625.00

12/03/98

AMERICAN-CANADIAN GENEALOGICAL SOCIETY**Balance Sheet**

As of November 30, 1998

Nov 30, '98**ASSETS****Current Assets****Checking/Savings****BUILDING FUND BNH** 688.94**CHECKING BNH** 9,453.64**CHEQUING (Can. Funds)** 1,402.21**SAVINGS SMB** 724.22**Total Checking/Savings** 12,269.01**Accounts Receivable****ACCOUNTS RECEIVABLE** 1,668.00**Total Accounts Receivable** 1,668.00**Other Current Assets****CASH ON HAND** 100.00**PETTY CASH** 300.00**Total Other Current Assets** 400.00**Total Current Assets** 14,337.01**Fixed Assets****LIBRARY BUILDING** 220,406.66**Total Fixed Assets** 220,406.66**Other Assets****ACGS HOLDINGS** 162,531.92**FURN & EQUIP** 60,746.98**MDSE FOR RESALE** 23,860.69**Total Other Assets** 247,139.59**TOTAL ASSETS** 481,883.26**LIABILITIES & EQUITY****Liabilities****Long Term Liabilities****BUILDING LOAN** 39,981.33**Total Long Term Liabilities** 39,981.33**Total Liabilities** 39,981.33**Equity****OPENING BAL EQUITY** 422,419.28**Net Income** 19,482.65**Total Equity** 441,901.93**TOTAL LIABILITIES & EQUITY** 481,883.26

12/03/98

AMERICAN-CANADIAN GENEALOGICAL SOCIETY INCOME & EXPENSE

November 1998

	Nov '98	Jan - Nov '98
Total Income	<u>10,692.43</u>	<u>125,778.31</u>
Gross Profit	10,692.43	125,778.31
Expense		
11.0 MEMBERSHIP		
11.1 Postage	200.00	1,400.00
11.2 Supplies	0.00	69.46
11.3 Maine	160.00	1,868.20
Total 11.0 MEMBERSHIP	<u>360.00</u>	<u>3,337.66</u>
12.0 PUBLICATIONS		
12.1 Postage	1.74	414.79
12.2 Supplies	0.00	1,136.13
12.3 Print Reps	632.95	4,556.85
12.4 Index & Holdings	0.00	465.50
12.5 Jette	0.00	3,559.00
Total 12.0 PUBLICATIONS	<u>634.69</u>	<u>10,132.27</u>
13.0 GENEALOGIST		
13.1 Postage	6.62	3,138.05
13.2 Supplies	0.00	558.16
13.3 Printing	0.00	14,489.00
Total 13.0 GENEALOGIST	<u>6.62</u>	<u>18,185.21</u>
14.0 LIBRARY		
14.1 Postage	0.00	50.21
14.2 Supplies	73.63	883.19
14.3 Equip Maint	0.00	907.51
14.4 Print Maps & Info	0.00	120.00
14.5 Beverages	0.00	441.00
14.6 Candy/Snacks	0.00	786.06
14.9 Other	0.00	54.07
Total 14.0 LIBRARY	<u>73.63</u>	<u>3,242.04</u>
15.0 RESEARCH		
15.1 Postage	97.24	207.24
15.2 Supplies	0.00	35.38
15.3 Returns	30.00	395.50
15.4 Parchemin	0.00	1,511.00
Total 15.0 RESEARCH	<u>127.24</u>	<u>2,149.12</u>
16.0 CONFERENCE		
16.1 Postage & Printing	0.00	2,343.56
16.3 Refreshments	0.00	0.00
16.4 Speakers	255.20	2,748.19
16.5 Caterer	-50.00	11,686.62
16.9 Other	0.00	1,756.88
Total 16.0 CONFERENCE	<u>205.20</u>	<u>18,535.25</u>
17.0 SOCIETY		
17.1 Postage	169.30	571.19
17.2 Supplies	1,161.73	3,737.44
17.3 Telephone	81.65	699.72

12/03/98

AMERICAN-CANADIAN GENEALOGICAL SOCIETY INCOME & EXPENSE

November 1998

	Nov '98	Jan - Nov '98
17.4 Work Comp Ins	0.00	-58.00
17.5 Liab Ins	0.00	1,222.00
17.6 Fire Ins	0.00	1,280.00
17.7 Bank Charge	9.50	50.69
17.8 Fund Expense	0.00	125.30
17.9 Other	105.00	3,292.77
Total 17.0 SOCIETY	1,527.18	10,921.11
18.0 BUILDING		
18.1 Heat	1,185.98	5,919.26
18.2 Electricity	247.00	2,683.60
18.3 Water-Sewer	85.88	452.82
18.5 Maint-Repair	927.90	24,137.45
18.6 Fire Protect	0.00	480.00
18.7 Snow-Grass	0.00	2,280.00
18.8 Loan Interest	341.50	3,839.87
Total 18.0 BUILDING	2,788.26	39,793.00
Uncategorized Expenses	0.00	0.00
Total Expense	5,722.82	106,295.66
Net Income	4,969.61	19,482.65

FUND BALANCES 30-Nov-98

ARCHIVIST FUND

	<i>Beginning Balance</i>			\$19,816.39
<i>Plus:</i>	<i>Membership</i>	\$5,254.00	20.00%	\$1,050.80
<i>Plus</i>	<i>Border Crossing Income</i>			
<i>Plus</i>	<i>Donations to Book Fund</i>			\$180.00
<i>Less:</i>	<i>Books Purchased/Binding, etc.</i>			<u>\$374.14</u>
	<i>Ending Balance</i>			<u>\$20,673.05</u>

RESEARCH FUND

	<i>Beginning Balance</i>			\$8,098.45
<i>Plus:</i>	<i>Current Month Receipts</i>			\$352.00
<i>Less:</i>	<i>Current Month Refunds</i>			\$30.00
<i>Less:</i>	<i>Postage & Misc. Expenses</i>			
<i>Less:</i>	<i>Purchase of Research Equip.</i>			
	<i>Ending Balance</i>			<u>\$8,420.45</u>

Parchemin Activity Report

<i>Date rcv'd by Month</i>	<i>Date rcv'd</i>	<i>Date Mailed</i>	<i>Surname</i>	<i>Name Rch'd</i>	<i>Total</i>
<i>November 1998</i>					
	05-Nov-98	05-Nov-98	Loring-Freeman	several	
	10-Nov-98		Morey	Morey/Shea/Moher/..	
	10-Nov-98	23-Nov-98	Gassette	Mimeau/Cornoier/Dut	
	10-Nov-98	04-Dec-98	Joubert	Joubert	
<i>Grand Total</i>					<input type="text"/>

Parchemin Income Report

<i>Surname</i>	<i>Total Paid</i>	<i>Date Paid</i>
Autotte	\$8.00	07-Nov-98
Joubert	\$14.00	28-Nov-98

Parchemin Aging Report

<i>Date rec'd by Month</i>	<i>Date rcv'd</i>	<i>Surname</i>	<i>Date billed</i>	<i>Amt billed</i>
----------------------------	-------------------	----------------	--------------------	-------------------

Grand Total

#Error

Research Dept. Aging Report

<i>DATE REC'D</i>	<i>SURNAME</i>	<i>LINE</i>
03-Nov-98	Gaudreau	Morin/Morrill
17-Nov-98	Lalonde	Lalonde
24-Nov-98	Goodwin	Huot
24-Nov-98	Goodwin	Lemelin

Reasearch Dept. Income Report

<i>DATE PAID by Month</i>	<i>SURNAME</i>	<i>AMOUNT PAID</i>	<i>DATE PAID</i>
-------------------------------	----------------	------------------------	------------------

November 1998

<i>Auger</i>	<i>\$10.00</i>	<i>11/3/98</i>
<i>Becht</i>	<i>\$20.00</i>	<i>11/20/98</i>
<i>Bureau</i>	<i>\$20.00</i>	<i>11/13/98</i>
<i>Bureau</i>	<i>\$20.00</i>	<i>11/13/98</i>
<i>Gelinas</i>	<i>\$20.00</i>	<i>11/24/98</i>
<i>Greenwood</i>	<i>\$6.00</i>	<i>11/5/98</i>
<i>Greenwood</i>	<i>\$20.00</i>	<i>11/9/98</i>
<i>Lalonde</i>	<i>\$25.00</i>	<i>11/13/98</i>
<i>LaPointe</i>	<i>\$50.00</i>	<i>11/16/98</i>
<i>Merrill</i>	<i>\$20.00</i>	<i>11/16/98</i>
<i>Miles</i>	<i>\$5.00</i>	<i>11/25/98</i>
<i>Paul</i>	<i>\$6.00</i>	<i>11/7/98</i>
<i>Poirier</i>	<i>\$5.00</i>	<i>11/4/98</i>
<i>Poirier</i>	<i>\$20.00</i>	<i>11/4/98</i>
<i>Poirier</i>	<i>\$40.00</i>	<i>11/5/98</i>
<i>Riley</i>	<i>\$20.00</i>	<i>11/12/98</i>
<i>Roy</i>	<i>\$20.00</i>	<i>11/16/98</i>
<i>Smith</i>	<i>\$40.00</i>	<i>11/2/98</i>
<i>Soucy</i>	<i>\$20.00</i>	<i>11/7/98</i>
<i>Soucy</i>	<i>\$20.00</i>	<i>11/10/98</i>
<i>Taylor</i>	<i>\$20.00</i>	<i>11/5/98</i>

Grand Total *\$427.00*

information for using the CDs.

Respectfully submitted,

Mary-Jean Chaput

Mary Jean Colburn
Oudens Memorial Library
UNH at Manchester
220 Hackett Hill Road
Manchester, NH 03102

mcolburn@cisunix.unh.edu
Tel. 603.629.4172
FAX 603.623.2745

Headers

Return-Path: <mcolburn@hopper.unh.edu>

Received: from rly-zc02.mx.aol.com (rly-zc02.mail.aol.com [172.31.33.2]) by air-zc01.mail.aol.com (v53.20) with SMTP; Mon, 07 Dec 1998 10:26:26 -0500

Received: from hopper.unh.edu (hopper.unh.edu [132.177.137.8])

by rly-zc02.mx.aol.com (8.8.8/8.8.5/AOL-4.0.0)

with ESMTP id KAA03061 for <cbelmain@aol.com>;

Mon, 7 Dec 1998 10:26:21 -0500 (EST)

Received: from localhost (mcolburn@localhost)

by hopper.unh.edu (8.9.1/8.9.1) with SMTP id KAA21248;

Mon, 7 Dec 1998 10:26:16 -0500 (EST)

Date: Mon, 7 Dec 1998 10:26:14 -0500 (EST)

From: Mary Jean Colburn <mj.colburn@unh.edu>

To: cbelmain@aol.com, cdonais@usa.net

Subject: Library Board Report (fwd)

Message-ID: <Pine.OSF.3.96L.981207102532.9299A-100000@hopper.unh.edu>

MIME-Version: 1.0

Content-Type: TEXT/PLAIN; charset=US-ASCII

Research Dept. Activity Report

<i>DATE REC'D</i>	<i>SURNAME</i>	<i>LINE</i>	<i>RS DONE Y</i>	<i>DATE MAILED</i>	<i>AMOUNT BILLED</i>	<i>DATE BILLED</i>	<i>REMARKS</i>
03-Nov-98	Gaudreau	Morin/Morrill					To do
03-Nov-98	Gaudreau	Morin	Yes	05-Nov-98	\$0.00		CNF
03-Nov-98	Greenwood	Pigeon	Yes	17-Nov-98	\$20.00	04-Nov-98	PDC
03-Nov-98	Hoefert	Thibaudeau	Yes	05-Nov-98	\$0.00		CNF
03-Nov-98	Methot/Walker	Methot	No	03-Nov-98			Wanted births, deaths, only. Referred to Vitals
03-Nov-98	Paul	Lajeunesse	Yes	04-Nov-98	\$6.00	04-Nov-98	3 generations only
03-Nov-98	Soucy	Fournier	Yes	17-Nov-98	\$20.00	05-Nov-98	PDC 11-5-98
03-Nov-98	Soucy	Fortier	Yes	23-Nov-98	\$20.00	06-Nov-98	PDC
05-Nov-98	Casey	Cassie/Casey	Y	05-Nov-98	\$0.00		CNF - PEI records
05-Nov-98	Turner, Jr	Martel	N	05-Nov-98	\$0.00		Add'l info requested
10-Nov-98	Auger	Auger	ffYes	10-Nov-98			Various copies
10-Nov-98	Clifford	O'Neil	Y	10-Nov-98	\$0.00		Referred to City Hall - records not avail.
10-Nov-98	Davis	Bourgeois	Y	10-Nov-98	\$0.00		Wants medical history
10-Nov-98	Fisher	Crooks	N	10-Nov-98	\$0.00		Add'l info requested
10-Nov-98	Van Wie	Lecompte	Yes	13-Nov-98	\$0.00		CNF - records not available
13-Nov-98	Becht	Venne	Yes	24-Nov-98	\$20.00	17-Nov-98	PDC
16-Nov-98	LaPointe						Donation for family research

<i>DATE REC'D</i>	<i>SURNAME</i>	<i>LINE</i>	<i>RS DONE Y</i>	<i>DATE MAILED</i>	<i>AMOUNT BILLED</i>	<i>DATE BILLED</i>	<i>REMARKS</i>
17-Nov-98	Beaulieu	Beaulieu	Yes	04-Dec-98	\$0.00		CNF referred to IL Vitals
17-Nov-98	Carty	Ricard	Yes		\$20.00	20-Nov-98	PDC 11-20-98
17-Nov-98	Gelinas	Roy	Yes	01-Dec-98	\$20.00	20-Nov-98	PDC
17-Nov-98	Lalonde	Lalonde					To do
17-Nov-98	Miles	Belanger	Yes	20-Nov-98	\$5.00	20-Nov-98	One generation only
17-Nov-98	Riley	Gratton	Yes	20-Nov-98			
17-Nov-98	Roy	Beaudoin	Yes	20-Nov-98			
17-Nov-98	Thomas	Richer	Yes	20-Nov-98	\$0.00		CNF
20-Nov-98	Doyon	Cadorette	Yes	04-Dec-98	\$0.00		CNF - referred to CT Vitals
24-Nov-98	Goodwin	Lemelin					To do
24-Nov-98	Goodwin	Huot					To do
01-Dec-98	Dube	Dube					To do
01-Dec-98	Poirier	Champagne	Yes		\$20.00	02-Dec-98	PDC 12-2-98
01-Dec-98	Poirier	Moreau	Yes		\$20.00	02-Dec-98	PDC 12-2-98
01-Dec-98	Wysocki	Arpin					To do

Subj: **Library Board Report (fwd)**
Date: 12/7/98 10:26:26 AM Eastern Standard Time
From: mj.colburn@unh.edu (Mary Jean Colburn)
To: cbelmain@aol.com, cdonais@usa.net

I will enter you in my address book for next time.
MJ

Mary Jean Colburn
Oudens Memorial Library
UNH at Manchester
220 Hackett Hill Road
Manchester, NH 03102

mcolburn@cisunix.unh.edu
Tel. 603.629.4172
FAX 603.623.2745

----- Forwarded message -----

Date: Fri, 4 Dec 1998 16:03:31 -0500 (EST)
From: Mary Jean Colburn <mcolburn@hopper.unh.edu>
To: hamellot@worldnet.att.net
Cc: amperrault@aol.com, chrysler@nh.ultranet.com,
cw3jack_stan@compuserve.com, malbaiepq@aol.com, mapaquette@grolen.com,
ram31@ix.netcom.com, RWMlawrenc@aol.com
Subject: Library Board Report

The Library Board met on November 30, 1998. Present: MaryAnna Paquette, Pauly Labbe, Donald Chaput, Anne-Marie Perrault, Roland Marchand, Bob Maurier, Al Hamel, Connie Hamel, Roger Lawrence, & Mary-Jean Chaput.

1. Floor plan, as updated by Roland, was accepted.
2. A lengthy discussion of extended hours. We will post 9 AM openings for Wed. and Fri. starting in December. Some people anticipate problems with getting volunteers to come in that early and some objected to the 3 hour shifts. We agreed to give it a try for a while and bring it back for discussion in the future. NOTE: AM Perrault said she would be available to open on Wed. and, in an emergency, on Fri.
3. Book loans to distant members was discussed. The majority of the board agrees with the concept. We are as yet unclear on how we could provide this service. There will be a work session for the board to review those books which will be available for loan to all members, distant or local.
4. The acquisitions committee consists of: Roland Marchand, Pauly Labbe, Diane Nault, Larry Autot, Richard Fortin, and Bob Maurier. They have not had much success meeting but will try to meet regularly, probably on a Sat. when most people can make it. They will also provide the board with a list of purchases.
5. A proposed 'Open House' is being planned by MaryAnna, Anne-Marie, and Pauly. We will also put an insert in the Journal in an attempt to get more people to volunteer.
6. Roland will work on a way to display or make available in some form,

December 7, 1998

TO: Board of Directors

FROM: Corresponding Secretary

SUBJECT: Report for Month of November 1998

The following correspondence was sent during the month of November:

- 17 "Thank yous" for donations of money to either the building fund or library fund. All were \$25.00 or less.
- 9 "Thanks yous" for donations of books and equipment, including a printer table and two printers (a NEC Silent Writer 95 and Epson Apex T-1000).
- 3 Application packets were sent in response to inquiries about ACGS.
- 2 Miscellaneous, including a sympathy card to the family of Fr. Charles d'Entremont.

31 Total

In addition, memos regarding the new key-pad lock system were distributed to all volunteers.

Respectfully submitted,
Mary Anna Paquette

TOTALS - SEPTEMBER 1998 to AUGUST 1999

MONTH	MONEY DONATIONS	BOOKS and Other Donations	INQUIRIES	MISC.	MONTH TOTAL
September	29	5	3	1	38
October	21	4	5	2	32
November	17	9	3	2	31
December					0
January					0
February					0
March					0
April					0
May					0
June					0
July					0
August					0
TOTALS	67	18	11	5	101

Subj: Editorial Board Meeting

Date: 12/9/98 7:19:31 AM Eastern Standard Time

From: AMPerrault

To: mcolburn@christa.unh.edu, mr.d6@juno.com

To: hamellot@worldnet.att.net, MalbaiePQ, RWMLawrenc

To: ram31@ix.netcom.com, BNeveux

To: mapaquette@grolen.com, AMPerrault

To: cw3jack_stan@juno.com, RLFortinNH, geco2@juno.com

To: robpaq@worldnet.att.net, chrysler@nh.ultranet.com

To: Donchaput, JudyA80476, cl-hebert@worldnet.att.net

To: lalo@worldpath.net, Cbelmain, cdonais@usa.net

The Editorial Board met on Tuesday, 8 DEC 1998, 2 PM, at the library. Topics discussed included the "orphan" publications for which the Board of Directors has made the responsibility of the Editorial Board. These are:

1. "Good Old Days" by Ray Desfosses
2. Mary Anna Paquette's "Holdings", third edition
3. Gerry Lalonde's "How-To" new edition
4. Anne-Marie Perrault's "Index to Articles in ACGenealogist", new edition
5. Henri Gosselin's unnamed novel
6. Surname Index, first edited by Dick Gagnon, second edition, by Bob Paquette, third edition upcoming.

Also Discussed: Moving President's Page and Editor's page to the colored insert section.

Good Old Days

Discussed possibility of adding to this with a section on "Little Canadas", especially to include Lowell, Massachusetts group which has become active, both at Lowell library and at ACGS; might request members to submit similar articles.

Holdings

Planning meetings for this will begin early in the new year, with a target publication date just prior to the Fall conference.

How-to Book

Planning meeting with Gerry Lalonde scheduled for January. Most probably, this publication will continue as a loose-leaf package.

Index to Articles

I hope to complete that this winter.

Henri Gosselin novel

Henri Gosselin will be here on Monday morning, 14 DEC. Anyone is welcome to meet him. I expect him at 10 AM. His book should be published in the spring. The Gosselin Family association will publish a French translation next year, in Quebec.

Surname Index

I will contact Bob Paquette to invite him to work with the Editorial Board on this project.

Conclusion:

Each project will have its own lead editor, with assistance being given by the other Board members.

Respectfully submitted,

Anne-Marie Perrault

Sam Harris <chrysler@nh.ultranet.com>

Subject: Computer Committee Report

Content-Type: text/plain; charset=us-ascii

Content-Transfer-Encoding: 7bit

Subj: **Computer Committee Report**

Date: 12/6/98 1:27:27 PM Eastern Standard Time

From: ram@ix.netcom.com (Roland A. Marchand)

To: hamellot@worldnet.att.net (Albert Hamel)

CC: amperrault@aol.com (Ann-Marie Perreault), cbelmain@aol.com (Carol A. Belmain), hebert@worldnet.att.net (Constance Hebert), cdonais@usa.net (Craig S. Donais), mcolburn@christa.unh.edu (Mary Jean Chaput), mapaquette@grolen.com (Mary-Anna Paquette), malbaiepq@aol.com (Pauly Labbe), RWWLawrenc@aol.com (Roger Lawrence), chrysler@nh.ultranet.com (Sam Harris)

Since the last board meeting, the hardware for the network was purchased and work on the installation continues. As of this writing the PRDH software has not arrived. A telephone to the vendor in Canada assures us that the CD's should arrive momentarily.

However, the initial delivery of the software will be the "french version". Later, the "english version" will come in January 1999.

So far, I have installed in the four 486 computers, the Windows 95 software. I also installed in each computer, the installation programs for most of the types of CD's that we currently posses. The largest program, Family Tree Maker resides only on the Pentium computer (the server) along with other family tree files for viewing. I do not know at this time how the PRDH program will be installed. It is now obvious that each of the four (client) computers are short in disk capacity. I am proposing that we increase these drives.

Also, one of the monitors on the 486 computer is fading away (part of a donated computer). I would like to suggest that the purchase a new one.

----- Headers -----

Return-Path: <ram@ix.netcom.com>

Received: from relay20.mx.aol.com (relay20.mail.aol.com [172.31.106.66]) by air09.mail.aol.com (v53.20) with SMTP; Sun, 06 Dec 1998 13:27:27 -0500

Received: from dfw-ix3.ix.netcom.com (dfw-ix3.ix.netcom.com [206.214.98.3])
by relay20.mx.aol.com (8.8.8/8.8.5/AOL-4.0.0)
with ESMTP id NAA26648;
Sun, 6 Dec 1998 13:27:21 -0500 (EST)

Received: (from smap@localhost)
by dfw-ix3.ix.netcom.com (8.8.4/8.8.4)
id MAA27285; Sun, 6 Dec 1998 12:27:01 -0600 (CST)

Received: from bsg-ma2a-91.ix.netcom.com(209.110.252.91) by dfw-ix3.ix.netcom.com via smap (V1.3)
id rma027256; Sun Dec 6 12:26:51 1998

Message-ID: <366ACC19.9FCC2127@ix.netcom.com>

Date: Sun, 06 Dec 1998 13:25:29 -0500

From: "Roland A. Marchand" <ram@ix.netcom.com>

X-Mailer: Mozilla 4.03 [en] (Win95; I)

MIME-Version: 1.0

To: Albert Hamel <hamellot@worldnet.att.net>

CC: Ann-Marie Perreault <amperrault@aol.com>,
"Carol A. Belmain" <cbelmain@aol.com>,
Constance Hebert <hebert@worldnet.att.net>,
"Craig S. Donais" <cdonais@usa.net>,
Mary Jean Chaput <mcolburn@christa.unh.edu>,
Mary-Anna Paquette <mapaquette@grolen.com>,
Pauly Labbe <malbaiepq@aol.com>, Roger Lawrence <RWWLawrenc@aol.com>,

Sheet1

RADIO SHACK PA SYSTEM						
Stock Number	Description	Quantity	Catalog Price	Sale Price	Extended Price	Page #
32-2003	100 Watt PA Amp w/mic mixer	1	249.99	249.99	\$250	128
40-2083	Shielded 2 way mini speaker 70 watts RMS	6	79.99	49.95	\$300	111
40-2095	Omni-Mounts speaker mounts/pair	3	59.99	59.99	\$180	111
32-1031B	Line Transformers 70v line	6	5.99	5.99	\$36	127
32-1235	2-channel , 170mhz audio link	1	99.99	79.99	\$80	132
32-1230	3-channel handheld wireless microphone	1	89.99	69.99	\$70	132
32-1231	3-channel lapel wireless microphone	1	79.99	49.99	\$50	132
278-1606	100 foot #16 speaker wire	2	17.95	17.95	\$36	
			Total		\$1,001	

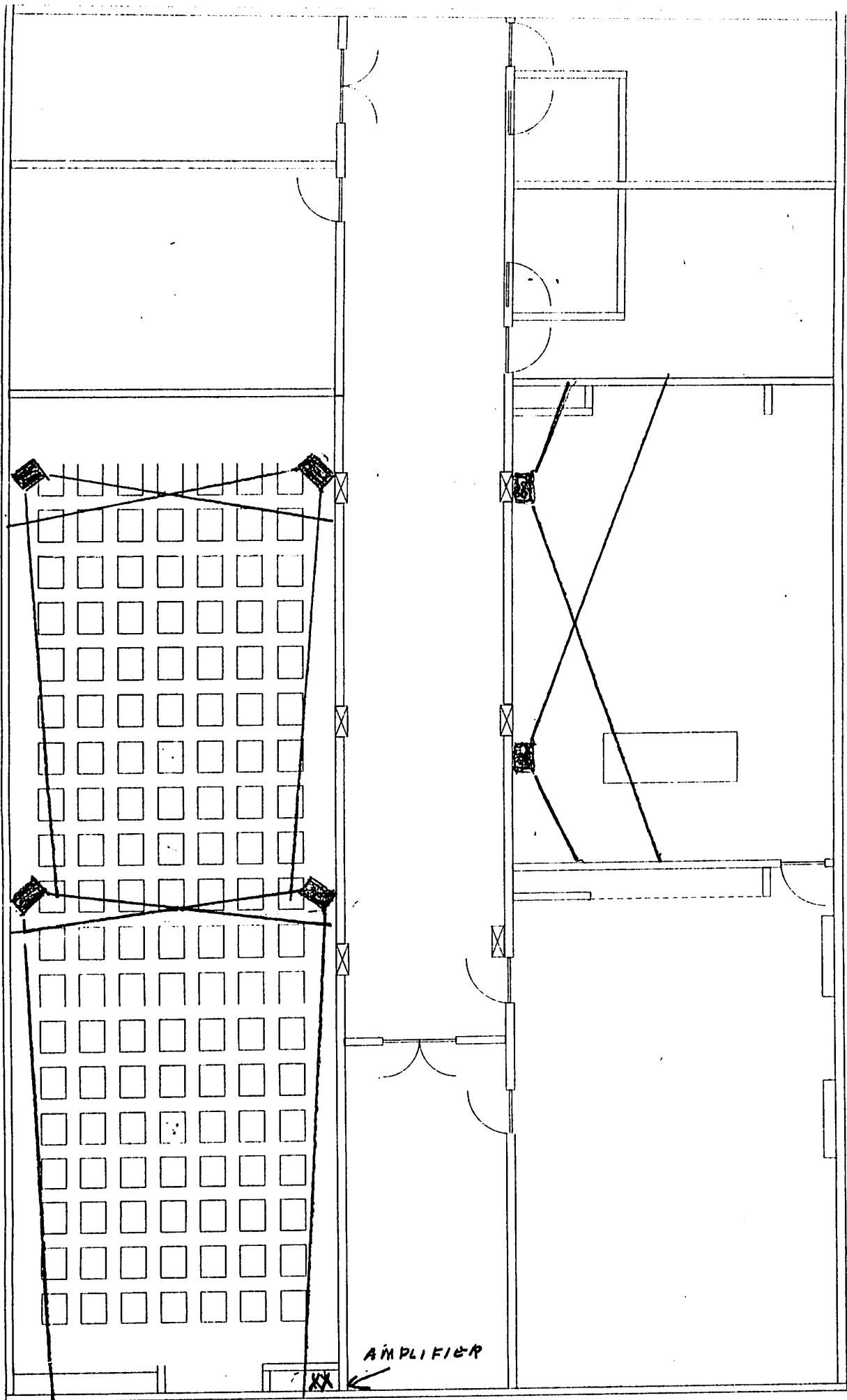

To the Budget & Finance Committee;

This package contains the following:

1. Financial History from 1994 to 1998
2. Financial Budget - a 5 year projection - 1999 to 2003
3. Summary Financial Budget for 1999 to 2003
4. Projected Annual Balance Sheet 1999 to 2003
5. Membership Growth from 1973 to 1998
6. List of Category and Account Numbers

NOTES TO HISTORICAL DATA:

There have been changes in account numbers over the years. In this project we use the most current account numbers and adjust historical data to fit these. This allows us to compare apples to apples. A few adjustments were made to historical data. For example, where we collected 6 months rent in one year and 18 months rent in the next, these were adjusted to reflect collection in the years due.

NOTES TO BUDGET DATA:

The membership figures reflect a projected net increase in membership of 100 per year. Each increase of 100 members can be expected to bring an increase in dues of \$2500, and an increase in the sale of other goods and services of \$2500, thus increasing income by \$5000.

MEMBERSHIP: The key to our success and financial future.

I believe that every officer and director has recognized that our strength lies in our membership. In 1993, when we went to banks to qualify for a line of credit sufficient to finance the purchase or construction of a library building, every loan officer we talked to commented favorably on our membership numbers as presented in the enclosed MEMBERSHIP GROWTH chart (in 1993 it covered only to 1992). In spite of this, all except one turned us down because we had only volunteers and no paid director (therefore, in their minds, no anchor, no stability). The one that accepted us was, of course, the Bank of New Hampshire. The loan officer, David Blais, told me after he had approved us for a line of credit of \$125,000, that our membership figures and the financial strength that those figures represented was what convinced him that we were a good financial risk.

Whenever we need a large infusion of funds for some great purpose, such as a data bank on CD Rom at \$50,000 or an elevator at \$120,000, we always turn to a fund drive, Grant letters, or bequests. A membership drive is not even mentioned. Too bad. An extra 300 members can bring in an extra \$15,000 per year. And since the average member stays with us for 12 years, that translates to \$180,000. That's more than our entire Library Holdings. I'm not saying, 'ignore fund drives' or anything else. What I am trying to do, is to point out to you and our Board of Directors that we should not ignore a vigorous membership drive. Our membership is our future.

A suggestion for a WORD OF MOUTH MEMBERSHIP DRIVE:

Let the entire membership be invited to participate in our membership drive. Members would receive one gift certificate for each new member brought in.

The gift certificate would be good for any goods or services of the Society, but not for dues. This plan would require the approval of the Board of Directors. At the same time, they can also decide on the dollar value of the gift certificates. I suggest from \$25 to \$50. The cost in goods of a \$25 gift certificate is about \$12. In services (Research, Parchemin) it is nothing more than the time of volunteers and paper and postage. A gift certificate might have appeal to members who wish to give it as a gift to a friend or relative who is into genealogy; perhaps, even the new recruit.

The announcement of the drive could be printed on a center colored page of the A-C Genealogist, with an application for membership printed at the bottom of the letter. The application should contain all the usual spaces for the information we need, plus a line for the name of the recruiter. A notice of the drive could be printed on the back cover to call attention to the center page.

This is an idea that, if successful, could produce huge returns. If it fails, it would cost the printing of an extra page in the A-C Genealogist. Not a bad deal !

Respectfully submitted:

Gerald Lalonde

FINANCIAL HISTORY 1994 TO 1998.xls

		1994	1995	1996	1997	1998	
						ESTIMATE	
INCOME							
1.1 Dues		40,632	41,153	55,588	61,185	62,000	
TOT MEMBERSHIP		40,632	41,153	55,588	61,185	62,000	
2.3 Repertoires		3,304	3,858	8,207	6,922	9,000	
2.4 Index & Holdings		181	680	462	694	400	
2.5 Jette		1,800	1,600	3,000	7,430	6,000	
2.6 Videos		236	190	77	44	10	
2.7 Border Crossings						100	
2.9 Other Income		174					
TOT. PUBLICATIONS		5,695	6,328	11,746	15,090	15,510	
3.1 Back Issues		1,966	2,183	2,061	1,815	700	
3.2 Advertising		150	208	50	175	100	
3.9 Other Income							
TOT GENEALOGIST		2,116	2,391	2,111	1,990	800	
4.1 Photocopies		4,213	5,169	6,397	3,573	4,000	
4.2 Maps, Charts & Guides		3,442	2,345	3,105	3,838	3,000	
4.3 Guest Fees		1,371	1,798	1,872	2,417	2,200	
4.5 Bererages						1,000	
4.6 Candy & snacks						700	
4.7 Hats						90	
4.8 Gift Certificates						25	
4.9 Other Income		224	1,169	2,129	1,844	800	
TOT. LIBRARY		9,250	10,481	13,503	11,672	11,815	
5.1 Research		4,446	5,251	5,057	4,507	4,400	
5.2 Parchemin						600	
TOT. RESEARCH		4,446	5,251	5,057	4,507	5,000	
6.1 Attendande Fees		1,810	3,025	3,124	2,604	14,300	
6.2 Raffle		2,603	2,938	1,565	2,905		
6.3 Refreshment & Entertain		52	23	71	540		
6.4 Vendor Tables						500	
6.5 Advertising						1,610	
6.9 Other Income							
TOT CONFERENCE		4,465	5,986	4,760	6,049	16,410	
7.2 Building fund		43,666	27,744	17,061	5,824	4,200	
7.3 Acquisition Fund						1,500	
7.4 Grants & Bequests							
7.6 Checking Acct Interest		301	192	195	260	130	
7.7 Building Fund Interest						130	
7.8 Savings Acct Interest						20	
7.9 Other Income		389	987	775	900	1,900	
TOT SOCIETY		44,356	28,923	18,031	6,984	7,880	

FINANCIAL HISTORY 1994 TO 1998.xls

		1994	1995	1996	1997	1998	
8.1 Rental Income			5,250	10,500	10,500	10,500	
8.9 Other Bldg Income							
TOT BUILDING		0	5,250	10,500	10,500	10,500	
TOTAL INCOME		110,960	105,763	121,296	117,977	129,915	
EXPENSES							
11.1 Postage		1,370	1,218	1,499	1,449	1,500	
11.2 Supplies		328	426	545	493	100	
11.3 Maine Dues		1,288	1,264	1,710	1,343	2,200	
11.9 Other Expenses					285		
TOT MEMBERSHIP		2,986	2,908	3,754	3,570	3,800	
12.1 Postage		270	181	378	560	500	
12.2 Supplies		102	516	1,228	758	1,200	
12.3 Printing Repertoires		2,453	4,086	3,427	4,664	5,000	
12.4 Printing Index & Holdings						500	
12.5 Jette			1,750	5,100	6,846	3,600	
12.6 Videos			220				
12.9 Other Expenses			1,212		36		
TOT PUBLICATIONS		2,825	7,965	10,133	12,864	10,800	
13.1 Postage		3,053	2,763	4,160	3,933	4,200	
13.2 Supplies			257	264	81	600	
13.3 Printing Genealogist		8,090	14,052	15,997	23,190	20,000	
13.9 Other Expenses							
TOT GENEALOGIST		11,143	17,072	20,421	27,204	24,800	
14.1 Postage		15	15	101	195	60	
14.2 Supplies		1,198	2,560	2,713	604	1,000	
14.3 Equipment maintenance		2,017	1,289	1,588	341	1,000	
14.4 Printing Maps & Charts		1,525	1,731	728	439	200	
14.5 Beverages						500	
14.6 Candy & Snacks						900	
14.7 Hats							
14.9 Other Expenses		575	530	1,787	1,425	60	
TOT LIBRARY		5,330	6,125	6,917	3,004	3,720	
15.1 Postage		151	142	233	263	200	
15.2 Supplies		12	45	157	459	50	
15.3 Research refunds		1,119	1,094	550	-15	400	
15.4 Parchemin Refunds						1,520	
15.9 Other Expenses		266	240				
TOT RESEARCH		1,548	1,521	940	707	2,170	
16.1 Postage & Printing		1,278	1,828	2,017	1,225	2,343	
16.2 Raffle Prizes							

FINANCIAL HISTORY 1994 TO 1998.xls

			1994	1995	1996	1997	1998	
16.3 Refreshments & Entertain				564	473	232		
16.4 Speakers			566	373	924		2,493	
16.5 Caterer							11,737	
16.9 Other Expenses			591	100	240	2,116	1,757	
TOT CONFERENCE			2,435	2,865	3,654	3,573	18,330	
17.1 Postage			249	172	378	686	500	
17.2 Supplies			1,782	571	2,130	1,910	3,000	
17.3 Telephone			737	863	1,081	753	750	
17.4 Worker Comp. Insurance								
17.5 Fire Insurance			2,316	1,619	905	2,482	1,222	
17.6 Liability Insurance							1,280	
17.7 Bank Charges			307	670	205	241	50	
17.8 Fund Raising Expenses			11,919	68	591	331	150	
17.9 Other Expenses			4,209	1,060	48	3,867	3,200	
TOT SOCIETY			21,519	5,023	5,338	10,270	10,152	
18.1 Heat			2,073	6,350	6,584	7,306	6,000	
18.2 Electricity			1,619	2,560	2,826	2,702	3,000	
18.3 Water & Sewer			632	676	495	491	453	
18.4 Building Insurance			1,240	1,150	1,168			
18.5 Maintenance & Repair				5,219	5,921	4,689	27,000	
18.6 Fire Protection			480	523	505	480	480	
18.7 Snow & Grass			7,164	1,384	4,339	3,270	2,300	
18.8 Loan Interest			4,912	6,263	4,025	1,713	3,850	
18.9 Other Expenses			296	252		150		
TOT BUILDING			18,416	24,377	25,863	20,801	43,083	
TOTAL EXPENSES			64,920	66,575	76,080	81,286	114,685	
NET INCOME			46,040	39,188	45,216	36,691	15,230	

FINANCIAL BUDGET - 5 YEAR PROJECTION.xls

	1999	2000	2001	2002	2003	TOTALS
INCOME						
1.1 Dues	65,000	67,500	70,000	72,500	75,000	350,000
TOT MEMBERSHIP	65,000	67,500	70,000	72,500	75,000	350,000
2.3 Repertoires	10,000	11,000	12,000	13,000	14,000	60,000
2.4 Index & Holdings	500	500	500	500	500	2,500
2.5 Jette	5,000	5,000	5,000	5,000	5,000	62,500
2.6 Videos						
2.7 Border Crossings	100	100	100	100	100	500
2.9 Other Income						
TOT. PUBLICATIONS	15,600	16,600	17,600	18,600	19,600	88,000
3.1 Back Issues	1,000	1,000	1,000	1,000	1,000	5,000
3.2 Advertising	100	150	150	200	200	800
3.9 Oter Income						
TOT. Genealogist	1,100	1,150	1,150	1,200	1,200	5,800
4.1 Photocopies	4,000	4,500	5,000	5,500	6,000	25,000
4.2 Maps, Charts & Guides	3,000	3,500	4,000	4,500	5,000	20,000
4.3 Guest Fees	2,300	2,400	2,500	2,600	2,700	45,000
4.5 Bererages	1,000	1,000	1,000	1,000	1,000	5,000
4.6 Candy & snacks						
4.7 Hats						
4.8 Gift Certificates						
4.9 Other Income						
TOT. LIBRARY	10,300	11,400	12,500	13,600	14,700	62,500
5.1 Research	4,900	5,100	5,300	5,500	5,700	26,500
5.2 Parchemin	1,500	1,500	1,500	1,500	1,500	7,500
TOT. RESEARCH	6,400	6,600	6,800	7,000	7,200	34,000
6.1 Attendande Fees	3,000	3,000	3,000	3,000	3,000	15,000
6.2 Raffle	2,500	2,500	2,500	2,500	2,500	12,500
6.3 Refreshment & Entertain	100	100	100	100	100	27,500
6.4 Vendor Tables	200	200	200	200	200	1,000
6.5 Advertising						
6.9 Other Income						
TOT CONFERENCE	5,800	5,800	5,800	5,800	5,800	29,000
7.2 Building fund	4,500	4,800	5,000	5,000	5,000	24,300
7.3 Acquisition Fund	1,500	1,500	1,500	1,500	1,500	7,500
7.4 Grants & Bequests						
7.6 Checking Acct Interest	100	100	100	100	100	500
7.7 Building Fund Interest	100	100	100	100	100	500
7.8 Savings Acct Interest	20	20	20	20	20	100
7.9 Other Income						
TOT SOCIETY	6,220	6,520	6,720	6,720	6,720	32,900

FINANCIAL BUDGET - 5 YEAR PROJECTION.xls

	1999	2000	2001	2002	2003	TOTALS
8.1 Rental Income	10,500	10,500	10,500	10,500	10,500	52,500
8.9 Other Bldg Income						
TOT BUILDING	10,500	10,500	10,500	10,500	10,500	52,500
TOTAL INCOME	120,920	126,070	131,070	135,920	140,720	654,700
EXPENSES						
11.1 Postage	1,500	1,500	1,600	1,600	1,700	7,900
11.2 Supplies	400	400	400	500	500	2,200
11.3 Maine Dues	2,000	2,100	2,200	2,300	2,400	10,100
11.9 Other Expenses						
TOT MEMBERSHIP	3,900	4,000	4,200	4,400	4,600	21,100
12.1 Postage	500	550	600	650	700	3,000
12.2 Supplies	1,000	1,000	1,000	1,200	1,200	5,400
12.3 Printing Repertoires	5,000	5,500	6,000	6,500	7,000	8,400
12.4 Printing Index & Holdings	200	200	600	300	300	1,600
12.5 Jette	3,000	3,000	3,000	3,000	3,000	15,000
12.6 Videos						
12.9 Other Expenses						
TOT PUBLICATIONS	9,700	10,250	11,200	11,650	12,200	55,000
13.1 Postage	4,200	4,400	4,600	4,800	5,000	23,000
13.2 Supplies	300	300	300	400	400	1,700
13.3 Printing Genealogist	20,000	22,000	24,000	24,000	25,000	24,700
13.9 Other Expenses						
TOT GENEALOGIST	24,500	26,700	28,900	29,200	30,400	139,700
14.1 Postage	50	50	50	60	60	270
14.2 Supplies	1,000	1,200	1,200	1,400	1,500	6,300
14.3 Equipment maintenence	300	400	500	600	600	6,570
14.4 Printing Maps & Charts	800	1,000	1,200	1,400	1,500	5,900
14.5 Beverages	600	600	600	600	600	3,000
14.6 Candy & Snacks						
14.7 Hats						
14.9 Other Expenses						
TOT LIBRARY	2,750	3,250	3,550	4,060	4,260	17,870
15.1 Postage	200	250	250	300	300	1,300
15.2 Supplies	100	100	100	100	100	500
15.3 Research refunds	500	500	500	500	500	1,800
15.4 Parchemin Refunds	20	20	20	20	20	100
15.9 Other Expenses	1,500	1,500	1,500	1,500	1,500	7,500
TOT RESEARCH	2,320	2,370	2,370	2,420	2,420	11,900
16.1 Postage & Printing	2,000	2,000	2,000	2,000	2,000	10,000
16.2 Raffle Prizes	400	400	400	500	500	2,200

FINANCIAL BUDGET - 5 YEAR PROJECTION.xls

	1999	2000	2001	2002	2003	TOTALS
16.3 Refreshments & Entertain	500	500	500	500	500	12,200
16.4 Speakers	1,000	1,000	1,000	1,000	1,000	5,000
16.5 Caterer						
16.9 Other Expenses						
TOT CONFERENCE	3,900	3,900	3,900	4,000	4,000	19,700
17.1 Postage	500	550	600	650	700	3,000
17.2 Supplies	3,000	3,200	3,400	3,600	3,800	17,000
17.3 Telephone	1,200	1,200	1,200	1,200	1,200	20,000
17.4 Worker Comp. Insurance	200	200	200	200	200	1,000
17.5 Fire Insurance	1,200	1,200	1,200	1,200	1,200	6,000
17.6 Liability Insurance	1,200	1,200	1,200	1,200	1,200	7,000
17.7 Bank Charges	60	70	80	80	80	370
17.8 Fund Raising Expenses	150	150	300	300	300	1,200
17.9 Other Expenses	2,000	2,000	2,000	2,000	2,000	1,570
TOT SOCIETY	9,510	9,770	10,180	10,430	10,680	50,570
18.1 Heat	6,000	6,000	6,000	6,000	6,000	30,000
18.2 Electricity	3,500	3,500	3,500	3,500	3,500	17,500
18.3 Warer & Sewer	500	500	500	500	500	47,500
18.4 Building Insurance						
18.5 Maintenance & Repair	6,000	6,000	6,000	6,000	6,000	30,000
18.6 Fire Protection	500	500	500	500	500	2,500
18.7 Snow & Grass	2,000	4,000	4,500	4,500	5,000	32,500
18.8 Loan Interest	4,000	3,000	2,000	1,000	0	10,000
18.9 Other Expenses						
TOT BUILDING	12,500	13,500	13,000	12,000	11,500	62,500
TOTAL EXPENSES	69,080	73,740	77,300	78,160	80,060	378,340
NET INCOME	51,840	52,330	53,770	57,760	60,660	276,360
CASH FLOW PROJECTION						
OPENING CASH BALANCE	10,000	31,840	52,170	72,940	96,700	263,650
DEBT REDUCTION	10,000	10,000	10,000	10,000	0	40,000
INCREASE IN HOLDINGS	15,000	17,000	18,000	19,000	20,000	89,000
INCREASE IN FURN & EQUIP	5,000	5,000	5,000	5,000	5,000	25,000
CASH FLOW	31,840	52,170	72,940	96,700	132,360	386,010

SUMMARY OF BUDGET FOR 1999 TO 2003						
	1999	2000	2001	2002	2003	TOTALS
INCOME						
MEMBERSHIP	65,000	67,500	70,000	72,500	75,000	350,000
PUBLICATIONS	15,600	16,600	17,600	18,600	19,600	88,000
GENEALOGIST	1,100	1,150	1,150	1,200	1,200	5,800
LIBRARY	10,300	11,400	12,500	13,600	14,700	62,500
RESEARCH	6,400	6,600	6,800	7,000	7,200	34,000
CONFERENCE	5,800	5,800	5,800	5,800	5,800	29,000
SOCIETY	6,220	6,520	6,720	6,720	6,720	32,900
BUILDING	10,500	10,500	10,500	10,500	10,500	52,500
TOTAL INCOME	120,920	126,070	131,070	135,920	140,720	654,700
EXPENSES						
MEMBERSHIP	3,900	4,000	4,200	4,400	4,600	21,100
PUBLICATIONS	9,700	10,250	11,200	11,650	12,200	55,000
GENEALOGIST	24,500	26,700	28,900	29,200	30,400	139,700
LIBRARY	2,750	3,250	3,550	4,060	4,260	17,870
RESEARCH	2,320	2,370	2,370	2,420	2,420	11,900
CONFERENCE	3,900	3,900	3,900	4,000	4,000	19,700
SOCIETY	9,510	9,770	10,180	10,430	10,680	50,570
BUILDING	12,500	13,500	13,000	12,000	11,500	62,500
TOTAL EXPENSE	69,080	73,740	77,300	78,160	80,060	378,340
NET INC BY DEPT						
MEMBERSHIP	61,100	63,500	65,800	68,100	70,400	328,900
PUBLICATIONS	5,900	6,350	6,400	6,950	7,400	33,000
GENEALOGIST	-23,400	-25,550	-27,750	-28,000	-29,200	-133,900
LIBRARY	7,550	8,150	8,950	9,540	10,440	44,630
RESEARCH	4,080	4,230	4,430	4,580	4,780	22,100
CONFERENCE	1,900	1,900	1,900	1,800	1,800	9,300
SOCIETY	-3,290	-3,250	-3,460	-3,710	-3,960	-17,670
BUILDING	-2,000	-3,000	-2,500	-1,500	-1,000	-10,000
NET INC BY DEPT	51,840	52,330	53,770	57,760	60,660	276,360

PROJECTED ANNUAL BALANCE SHEET as of DEC. 31 of 1999 to 2003								
			OPENING	1999	2000	2001	2002	2003
ASSETS								
Cash & Equivalents			11,000	41,000	62,000	84,000	97,000	132000
Building			220,000	220,000	220,000	220,000	220,000	220000
Holdings			165,000	180,000	197,000	215,000	234,000	254000
Furn & Equip			60,000	65,000	70,000	75,000	80,000	85000
Mdse for Resale			24,000	24,000	24,000	24,000	24,000	24000
TOTAL ASSETS			480,000	530,000	573,000	618,000	655,000	715000
LIABILITIES & EQUITY								
LIABILITIES								
Building Loan			40,000	30,000	20,000	10,000	0	0
TOTAL LIABILITIES			40,000	30,000	20,000	10,000	0	0
EQUITY								
Opening Balance Equity			440,000	480,000	530,000	573,000	618,000	655,000
Retained Earnings				20,000	23,000	35,000	37,000	60000
TOTAL EQUITY			440,000	500,000	553,000	608,000	655,000	715,000
TOTAL LIAB & EQUITY			480,000	530,000	573,000	618,000	655,000	715,000

MEMBERSHIP GROWTH FROM 1973 TO 1998							
DATE	LAST MEMBER	NEW	DROP	TOTAL	ACTIVE	NET	
	NUMBER ISSUED	MEMB	OUTS *	MEMBERSHIP **		INC.	
Dec. 1973	78	78	0		78	0	
Nov. 1974	166	88	10		156	78	
Oct. 1975	258	92	20		228	72	
Aug. 1976	376	118	30		316	88	
Aug. 1977	495	119	40		395	79	
Aug. 1978	766	271	70		596	201	
Aug. 1979	1033	267	80		783	187	
Aug. 1980	1262	229	90		922	139	
Aug. 1981	1464	202	110		1014	92	
Aug. 1982	1700	236	120		1130	116	
Fall 1983	1900	200	130		1200	70	
Fall 1984	2138	238	140		1298	98	
Fall 1985	2351	213	150		1361	63	
Fall 1986	2563	212	160		1413	52	
Fall 1987	2792	229	170		1472	59	
Fall 1988	3045	253	180		1545	73	
Fall 1989	3271	226	190		1581	36	
Fall 1990	3591	320	200		1701	120	
Fall 1991	3974	383	240		1844	143	
Fall 1992	4321	347	240		1951	107	
Fall 1993	4675	354	260		2045	94	
Fall 1994	5162	487	280		2252	207	
Fall 1995	5719	557	280		2529	277	
Fall 1996	6181	462	280		2711	182	
Fall 1997	6633	452	290		2873	162	
Fall 1998	7016	383	241		3015	142	
* Since we did not keep track of drop-outs from 1973 to 1997, the above figures are estimates. For 1998 the figure is the total number of new members minus the increase in total membership.							
** Includes Societies with whom we swap periodicals but pay no dues, and family members who pay half price but do not receive the A-C genealogist.							
From 1990 to 1995 our Society has shown steady growth. However, for the past three years our rate of growth has fallen off. Perhaps it is time we put some effort into recruiting new members. Suggestions on how to go about this are welcome. One suggestion is attached for your consideration.							

AMERICAN-CANADIAN GENEALOGICAL SOCIETY

10/14/98

Account Detail

October 14, 1998

Account	Account	Account
BUILDING FUND BNH	7.0 SOCIETY:7.3 Book Fund	17.0 SOCIETY:17.3 Telephone
CHECKING BNH	7.0 SOCIETY:7.4 Grants Rec'd	17.0 SOCIETY:17.4 Work Comp Ins
CHEQUING (Can. Funds)	7.0 SOCIETY:7.5 Bequests	17.0 SOCIETY:17.5 Liab Ins
SAVINGS SMB	7.0 SOCIETY:7.6 Ckg Act Int	17.0 SOCIETY:17.6 Fire Ins
ACCOUNTS RECEIVABLE	7.0 SOCIETY:7.7 Bld Fnd Int	17.0 SOCIETY:17.7 Bank Charge
CASH ON HAND	7.0 SOCIETY:7.8 Sav Act Int	17.0 SOCIETY:17.8 Fund Expense
Inventory Asset	7.0 SOCIETY:7.9 Other	17.0 SOCIETY:17.9 Other
PETTY CASH	8.0 BUILDING	18.0 BUILDING
LIBRARY BUILDING	8.0 BUILDING:8.1 Rental Inc	18.0 BUILDING:18.1 Heat
ACGS HOLDINGS	8.0 BUILDING:8.9 Other	18.0 BUILDING:18.2 Electricity
FURN & EQUIP	Uncategorized Income	18.0 BUILDING:18.3 Water-Sewer
GAS CO. DEPOSIT	Cost of Goods Sold	18.0 BUILDING:18.4 Bldg Ins
MDSE FOR RESALE	11.0 MEMBERSHIP	18.0 BUILDING:18.5 Maint-Repair
ACCOUNTS PAYABLE	11.0 MEMBERSHIP:11.1 Postage	18.0 BUILDING:18.6 Fire Protect
BUILDING LOAN	11.0 MEMBERSHIP:11.2 Supplies	18.0 BUILDING:18.7 Snow-Grass
OPENING BAL EQUITY	11.0 MEMBERSHIP:11.3 Maine	18.0 BUILDING:18.8 Loan Interest
RETAINED EARNINGS	11.0 MEMBERSHIP:11.9 Other	18.0 BUILDING:18.9 Other
1.0 MEMBERSHIP	12.0 PUBLICATIONS	Uncategorized Expenses
1.0 MEMBERSHIP:1.1 Dues	12.0 PUBLICATIONS:12.1 Postage	Purchase Orders
2.0 PUBLICATIONS	12.0 PUBLICATIONS:12.2 Supplies	
2.0 PUBLICATIONS:2.1 Spare Account	12.0 PUBLICATIONS:12.3 Print Reps	
2.0 PUBLICATIONS:2.2 Spare Acct.	12.0 PUBLICATIONS:12.4 Print Index ...	
2.0 PUBLICATIONS:2.3 Repertoires	12.0 PUBLICATIONS:12.5 Jette	
2.0 PUBLICATIONS:2.4 Index & Holdi...	12.0 PUBLICATIONS:12.6 Videos	
2.0 PUBLICATIONS:2.5 Jette	12.0 PUBLICATIONS:12.9 Other	
2.0 PUBLICATIONS:2.6 Video S. R.	13.0 GENEALOGIST	
2.0 PUBLICATIONS:2.7 Border Crossi...	13.0 GENEALOGIST:13.1 Postage	
2.0 PUBLICATIONS:2.9 Other	13.0 GENEALOGIST:13.2 Supplies	
3.0 GENEALOGIST	13.0 GENEALOGIST:13.3 Printing	
3.0 GENEALOGIST:3.1 Back Issues	13.0 GENEALOGIST:13.9 Other	
3.0 GENEALOGIST:3.2 Advertising	14.0 LIBRARY	
3.0 GENEALOGIST:3.9 Other	14.0 LIBRARY:14.1 Postage	
4.0 LIBRARY	14.0 LIBRARY:14.2 Supplies	
4.0 LIBRARY:4.1 All Copies	14.0 LIBRARY:14.3 Equip Maint	
4.0 LIBRARY:4.2 Maps-Charts-Guides	14.0 LIBRARY:14.4 Print Maps & Info	
4.0 LIBRARY:4.3 Guest Fees	14.0 LIBRARY:14.5 Beverages	
4.0 LIBRARY:4.4 Spare Account	14.0 LIBRARY:14.6 Candy/Snacks	
4.0 LIBRARY:4.5 Beverages	14.0 LIBRARY:14.7 Hats	
4.0 LIBRARY:4.6 Candy/Snacks	14.0 LIBRARY:14.9 Other	
4.0 LIBRARY:4.7 Hats	15.0 RESEARCH	
4.0 LIBRARY:4.8 Gift Certificates	15.0 RESEARCH:15.1 Postage	
4.0 LIBRARY:4.9 Other	15.0 RESEARCH:15.2 Supplies	
5.0 RESEARCH	15.0 RESEARCH:15.3 Returns	
5.0 RESEARCH:5.1 RS Income	15.0 RESEARCH:15.4 Parchemin	
5.0 RESEARCH:5.2 Parchemin	15.0 RESEARCH:15.9 Other	
6.0 CONFERENCE	16.0 CONFERENCE	
6.0 CONFERENCE:6.1 Attend Fees	16.0 CONFERENCE:16.1 Postage & P...	
6.0 CONFERENCE:6.2 Raffle	16.0 CONFERENCE:16.2 Raffle Prizes	
6.0 CONFERENCE:6.3 Refreshment I...	16.0 CONFERENCE:16.3 Refreshments	
6.0 CONFERENCE:6.4 Vendor Booth	16.0 CONFERENCE:16.4 Speakers	
6.0 CONFERENCE:6.5 Advertising	16.0 CONFERENCE:16.5 Caterer	
6.0 CONFERENCE:6.9 Other	16.0 CONFERENCE:16.9 Other	
7.0 SOCIETY	17.0 SOCIETY	
7.0 SOCIETY:7.1 Gen. Fund	17.0 SOCIETY:17.1 Postage	
7.0 SOCIETY:7.2 Bldg Fund	17.0 SOCIETY:17.2 Supplies	

NH398 NEW HAMPSHIRE 1850 MORTALITY SCHEDULES. Ronald Vern Jackson 45.00

ISBN 0-89593-425-6 1986, 1997

NH196 NEW HAMPSHIRE 1860 FEDERAL CENSUS INDEX Ronald Vern Jackson 125.00

ISBN 0-89593-851-0 1986, 1997

NH914 NEW HAMPSHIRE 1890 VETERANS CENSUS INDEX. Ronald Vern Jackson 55.00

ISBN 0-89593-606-8 1986, 1997

NH571 NEW HAMPSHIRE EARLY CENSUS INDEX . Ronald Vern Jackson 45.00

ISBN 0-89593-732-8 1981 , 1997

NH081 NEW HAMPSHIRE 1790 FEDERAL CENSUS INDEX. Ronald Vern Jackson 45.00

ISBN 0-89593-694-1 1978, 1997

H135 NEW HAMPSHIRE 1800 FEDERAL CENSUS INDEX. Ronald Vern Jackson 50.00

ISBN 0-89593-083-8 1974, 1997

NH324 NEW HAMPSHIRE 1810 FEDERAL CENSUS INDEX Ronald Vern Jackson 55.00

ISBN 0-89593-695-X 1976, 1997

NH016 NEW HAMPSHIRE 1820 FEDERAL CENSUS INDEX Ronald Vern Jackson 60.00

ISBN 0-89593-085-4 1976, 1997

NH082 NEW HAMPSHIRE 1830 FEDERAL CENSUS INDEX Ronald Vern Jackson 60.00

ISBN 0-89593-086-2 1977, 1997

NH104 NEW HAMPSHIRE 1840 FEDERAL CENSUS INDEX Ronald Vern Jackson 65.00

ISBN 0-89593-087-0 1976, 1997

NH364 NEW HAMPSHIRE 1850 FEDERAL CENSUS INDEX Ronald Vern Jackson 75.00

ISBN 0-89593-088-9 1978, 1997

NH398 NEW HAMPSHIRE 1850 MORTALITY SCHEDULES. Ronald Vern Jackson 45.00

ISBN 0-89593-425-6 1986, 1997

NH196 NEW HAMPSHIRE 1860 FEDERAL CENSUS INDEX Ronald Vern Jackson 125.00

ISBN 0-89593-851-0 1986, 1997

NH914 NEW HAMPSHIRE 1890 VETERANS CENSUS INDEX. Ronald Vern Jackson 55.00

ISBN 0-89593-696-8 1985, 1997

ME602 MAINE 1890 VETERANS CENSUS INDEX. Ronald Vern Jackson 90.00

ISBN 0-89593-362-4 1991, 1997

Original census may be searched at the LDS Family History Library or the National Archives.

VERMONT

VT568 VERMONT EARLY CENSUS INDEX. Ronald Vern Jackson 50.00

ISBN 0-89593-747-6 1980, 1997

VT158 VERMONT 1790 FEDERAL CENSUS INDEX (1908) Ronald Vern Jackson 45.00

ISBN 0-89593-790-5 1978, 1997

VT100 VERMONT 1790 FEDERAL CENSUS INDEX (1990) Ronald Vern Jackson 70.00

ISBN 0-89593-945-2 1990, 1997

VT188 VERMONT 1800 FEDERAL CENSUS INDEX. Ronald Vern Jackson 55.00

ISBN 0-89593-214-8 1981, 1997

VT327 VERMONT 1810 FEDERAL CENSUS INDEX. Ronald Vern Jackson 55.00

ISBN 0-89593-141-9 1976, 1997

VT019 VERMONT 1820 FEDERAL CENSUS INDEX. Ronald Vern Jackson 60.00

ISBN 0-89593-142-7 1976, 1997

VT381 VERMONT 1830 FEDERAL CENSUS INDEX. Ronald Vern Jackson 65.00

ISBN 0-89593-143-5 1977, 1997

VT382 VERMONT 1840 FEDERAL CENSUS INDEX. Ronald Vern Jackson 70.00

ISBN 0-89593-144-3 1978, 1997

VT383 VERMONT 1850 FEDERAL CENSUS INDEX. Ronald Vern Jackson 140.00

ISBN 0-89593-145-1 1978, 1997

VT707 VERMONT 1850 MORTALITY SCHEDULES. Ronald Vern Jackson 45.00

ISBN 0-89593-515-5 1980, 1997

VT239 VERMONT 1860 FEDERAL CENSUS INDEX. Ronald Vern Jackson 160.00

ISBN 0-89593-516-3 1987, 1997

VT699 VERMONT 1860 MORTALITY SCHEDULES. Ronald Vern Jackson 45.00

ISBN 0-89593-517-1 1980, 1997

VT068 VERMONT 1870 MORTALITY SCHEDULES INDEX. Ronald Vern Jackson 55.00

ISBN 0-89593-860-X 1989, 1997

VT923 VERMONT 1890 VETERANS CENSUS INDEX. Ronald Vern Jackson 50.00

ISBN 0-89593-791-3 1979, 1997

CANADA

ALBERTA 1881 & 1891 SEE NORTHWEST TERRITORIES

CAN851 BRITISH COLUMBIA 1881 CENSUS INDEX. Ronald Vern Jackson 90.00

ISBN 0-89593-543-0 1986, 1997

CAN965 MANITOBA 1881 CENSUS INDEX. Ronald Vern Jackson 100.00

ISBN 0-89593-238-5 1986, 1997

CAN964 NEW BRUNSWICK 1851 CENSUS INDEX. Ronald Vern Jackson 85.00

ISBN 0-89593-239-3 1986, 1997

CAN966 NORTHWEST TERRITORIES 1881 CENSUS INDEX. Ronald Vern Jackson 90.00

(INCLUDES ALBERTA, SASKATCHEWAN & YUKON TERRITORY)

ISBN 0-89593-240-7 1986, 1997

CAN968 NOVA SCOTIA 1770-1787 CENSUS INDEX. Ronald Vern Jackson 35.00

ISBN 0-89593-233-4 1985, 1997

CAN963 NOVA SCOTIA 1851 HALIFAX AND KINGS COUNTY CENSUS INDEX. 85.00

Ronald Vern Jackson. ISBN 0-89593-241-5 1986, 1997

CAN277 ONTARIO 1800-1842 CENSUS INDEX. (Misc. Sources) Ronald Vern Jackson 55.00

ISBN 0-89593-234-2 1985, 1997

CAN267 ONTARIO (UPPER CANADA) 1848/1850 CENSUS HURON, JOHNSTON AND 95.00

AND NEW CASTLE COUNTIES. Ronald Vern Jackson

INDEX ISBN 0-89593-762-X 1986, 1997

CAN-CDO1 ONTARIO CEMETERY FINDING AID. CD-ROM 29.95

INDEX OF OVER 2,400 CEMETERIES. 1.2 MILLION NAMES OF PERSONS

BURIED IN ONTARIO, CANADA. WIN/MAC GENREF. 1996.

** SASKATCHEWAN 1881 & 1891. SEE NORTHWEST TERRITORIES

** YUKON TERRITORIES 1881 & 1891

SEE NORTHWEST TERRITORIES

The Family History Bundle — A 65% Savings

High-Quality Resources That Offer Great Value and Variety

Holiday
Bundle Bonanza

Your family's history is like a tapestry, filled with rich and colorful content. As genealogies stretch beyond living memory, however, we rely more on stark dates and place names. The Family History Bundle's 5 CDs present 24 volumes of family genealogy collections that include a broad selection of resources and narrative text that allows for a much fuller and complete picture of your ancestors' lives.

The images of actual pages from popular genealogy books published by the Genealogical Publishing Company reference over 338,000 individuals from the most popular regions and time periods for genealogical research. Sources include family genealogies, cemetery records, church records, bible records, marriage records, vital records, land records, court records and

death records. With name indexes on each CD, a powerful searching tool, and Broderbund's 90-day money-back guarantee, this one-stop resource of high-quality records is a fantastic value at \$59.99, a 65% savings off the regular price of the individual CDs listed below.

- ❖ Connecticut Genealogies #1, 1600s-1800s (CD# 179)
- ❖ Virginia Genealogies #1, pre-1600 to 1900s (CD# 162)
- ❖ New Jersey Genealogies #1, 1600s-1800s (CD# 182)
- ❖ Pennsylvania Genealogies #1, pre-1600 to 1900s (CD# 163)
- ❖ Rhode Island Genealogies #1, 1600s-1800s (CD# 180)

GPC Family History Bundle \$59.99

U.S. Census Bundle...Covers All 50 States

Each one of our U.S. Census Indexes includes records from many different states, so you can dig deeper and more quickly with a single search than you could with almost any other research method. There's one CD for early colonial times, and ten others that cover one decade each for the years 1790 to 1880. When you find an ancestor's name in a Census Index, you can learn the state, county, locality, year and page number of the census — so you know where to find copies of the actual documents in government records. The table at right shows which states and census years are included on one or more of the 11 CDs in the Census Bundle (CDs 310-320). For a listing of the specific information on each CD, go to our Web site: www.familytreemaker.com/bundles.html#census

AK: 1800, 1870, 1880	IA: 1830-1870	MT: 1860, 1870	
AL: 1780-1790, 1810-1880	ID: 1860-1880	NC: 1780-1870	
AR: 1810-1870	IL: 1780-1790, 1810-1880	ND: 1870, 1880	RI: 1780-1850
AZ: 1830, 1860-1880	IN: 1790-1870	NE: 1790, 1850, 1860	SC: 1780-1860
CA: 1790, 1800, 1830, 1850-1870	KS: 1850-1870	NH: 1780-1860	SD: 1870, 1880
CO: 1860-1880	KY: 1790-1870	NJ: 1780-1860	TN: 1790-1860
CT: 1780-1860	LA: 1780-1870	NM: 1790, 1820, 1840-1870	TX: 1820-1880
DC: 1780-1870	MA: 1780-1860	NV: 1860-1880	UT: 1850, 1860
DE: 1780-1870	MD: 1780-1820, 1840, 1850	NY: 1790-1860, 1880	VA: 1780-1870
FL: 1820-1870	ME: 1780-1870	OH: 1780-1850, 1880	VT: 1780-1860
GA: 1780-1870	MI: 1780-1850	OK: 1860	WA: 1860, 1870
HI: 1840	MN: 1830-1870	OR: 1850	WI: 1820-1870
	MO: 1780-1810, 1830-1850	PA: 1780-1860	WV: 1860, 1870
	MS: 1780-1860		WY: 1870, 1880

Sold separately for about \$320, the U.S. Census Bundle collection is yours for just \$199.99!

Marriage Bundle...A Comprehensive Resource

Marriage indexes are very popular because they provide information about two people at once (husband and wife) rather than just one person. By showing you where two family lines join into one, marriage indexes open up entire new generations for you to research. Also, marriage indexes are often one of the few sources of information about female ancestors, since women were not routinely noted by the U.S. census prior to 1850. This collection indexes over 3 million names, spanning over two centuries, for only \$199.99!

CD #	States Covered	Period	# of Names
1	LA	1718-1925	285,000
2	IL, IN, KY, OH, TN	1720-1926	369,000
3	AL, GA, SC	1641-1944	190,000
4	MD, NC, VA	1624-1915	250,000
5	AR, MO, MS, TX	1766-1981	524,000
6	AR	1779-1992	154,000
225	AZ, CA, ID, NV	1850-1951	146,000
226	GA	1754-1850	84,000
227	AR, CA, IA, LA, MN, MO, OR, TX	1728-1850	108,000
228	IL, IN	1790-1850	190,000
229	KY, NC, TN, VA, WV	1728-1850	582,000
400	OH	1789-1850	303,000

A \$339.88 value for just \$199.99. A great value for an excellent genealogical resource

Order by Phone: 1-800-548-1806 Anytime

Order Online: www.familytreemaker.com/holiday Anytime



11



American-Canadian Genealogical Society

Founded in September 1973

Tax Exempt: 501(c)(3)

Leaders in French-Canadian Genealogical Research

December 31, 1998

Ms. Audrey Blodgett
NH Charitable Trust
Justice Department
33 Capitol Street
Concord, NH 03301

Re: Conflict of Interest Policy

Dear Ms. Blodgett:

Pursuant to the Attorney General's letter of May 8, 1998, enclosed you will find a copy of the American Canadian Genealogical Society's minutes of the November 12, 1998, meeting wherein a motion to promulgate a conflict of interest policy was passed.

Also enclosed is a copy of the forms which were signed by all the board members, except for Charles Martel. A list of all board members is enclosed for your information.

Please do not hesitate to contact me should you have any questions in this matter.

Very truly yours,

Albert Hamel, President

ah/cab
Enc.

AMERICAN-CANADIAN GENEALOGICAL SOCIETY
4 ELM STREET
MANCHESTER, NH 03108-6478

CONFLICT OF INTEREST POLICY STATEMENT

Any possible conflict of interest on the part of any member of the Board, officer or employee of the Corporation, shall be disclosed in writing to the Board and made a matter of record through an annual procedure and also when the interest involves a specific issue before the Board.

Where the transaction involving a board member, trustee or officer exceeds five hundred dollars (\$500) but is less than five thousand dollars (\$5,000) in a fiscal year, a two-thirds vote of the disinterested directors is required.

Where the transaction involved exceeds five thousand dollars (\$5,000) in a fiscal year, than a two-thirds vote of the disinterested directors and publication in the newspaper is required.

The minutes of the meeting shall reflect that a disclosure was made, the abstention from voting, and the actual vote itself.

Every new member of the Board will be advised of this policy upon entering the duties of his or her office, and shall sign a statement acknowledging, understanding of and agreement to this policy. The Board will comply with all requirements of New Hampshire law in this area and the New Hampshire requirements are incorporated into and made a part of this policy statement.

I, Albert W. Hamel, have read the above policy statement as it relates to Conflict of Interest and understand the contents thereof.

Date:

10 December 1998

Albert W. Hamel
Signature

AMERICAN-CANADIAN GENEALOGICAL SOCIETY
4 ELM STREET
MANCHESTER, NH 03108-6478

CONFLICT OF INTEREST POLICY STATEMENT

Any possible conflict of interest on the part of any member of the Board, officer or employee of the Corporation, shall be disclosed in writing to the Board and made a matter of record through an annual procedure and also when the interest involves a specific issue before the Board.

Where the transaction involving a board member, trustee or officer exceeds five hundred dollars (\$500) but is less than five thousand dollars (\$5,000) in a fiscal year, a two-thirds vote of the disinterested directors is required.

Where the transaction involved exceeds five thousand dollars (\$5,000) in a fiscal year, than a two-thirds vote of the disinterested directors and publication in the newspaper is required.

The minutes of the meeting shall reflect that a disclosure was made, the abstention from voting, and the actual vote itself.

Every new member of the Board will be advised of this policy upon entering the duties of his or her office, and shall sign a statement acknowledging, understanding of and agreement to this policy. The Board will comply with all requirements of New Hampshire law in this area and the New Hampshire requirements are incorporated into and made a part of this policy statement.

I, ROLAND A. MARCHAND have read the above policy statement as it relates to Conflict of Interest and understand the contents thereof.

Date: 10 DEC 1998

Roland A. Marchand
Signature

AMERICAN-CANADIAN GENEALOGICAL SOCIETY
4 ELM STREET
MANCHESTER, NH 03108-6478

CONFLICT OF INTEREST POLICY STATEMENT

Any possible conflict of interest on the part of any member of the Board, officer or employee of the Corporation, shall be disclosed in writing to the Board and made a matter of record through an annual procedure and also when the interest involves a specific issue before the Board.

Where the transaction involving a board member, trustee or officer exceeds five hundred dollars (\$500) but is less than five thousand dollars (\$5,000) in a fiscal year, a two-thirds vote of the disinterested directors is required.

Where the transaction involved exceeds five thousand dollars (\$5,000) in a fiscal year, than a two-thirds vote of the disinterested directors and publication in the newspaper is required.

The minutes of the meeting shall reflect that a disclosure was made, the abstention from voting, and the actual vote itself.

Every new member of the Board will be advised of this policy upon entering the duties of his or her office, and shall sign a statement acknowledging, understanding of and agreement to this policy. The Board will comply with all requirements of New Hampshire law in this area and the New Hampshire requirements are incorporated into and made a part of this policy statement.

I, GERALD LALONDE, have read the above policy statement as it relates to Conflict of Interest and understand the contents thereof.

Date:

12-10-98

Gerald Lalonde
Signature

AMERICAN-CANADIAN GENEALOGICAL SOCIETY
4 ELM STREET
MANCHESTER, NH 03108-6478

CONFLICT OF INTEREST POLICY STATEMENT

Any possible conflict of interest on the part of any member of the Board, officer or employee of the Corporation, shall be disclosed in writing to the Board and made a matter of record through an annual procedure and also when the interest involves a specific issue before the Board.

Where the transaction involving a board member, trustee or officer exceeds five hundred dollars (\$500) but is less than five thousand dollars (\$5,000) in a fiscal year, a two-thirds vote of the disinterested directors is required.

Where the transaction involved exceeds five thousand dollars (\$5,000) in a fiscal year, than a two-thirds vote of the disinterested directors and publication in the newspaper is required.

The minutes of the meeting shall reflect that a disclosure was made, the abstention from voting, and the actual vote itself.

Every new member of the Board will be advised of this policy upon entering the duties of his or her office, and shall sign a statement acknowledging, understanding of and agreement to this policy. The Board will comply with all requirements of New Hampshire law in this area and the New Hampshire requirements are incorporated into and made a part of this policy statement.

I, MARY ANNA PAQUETTE, have read the above policy statement as it relates to Conflict of Interest and understand the contents thereof.

Date:

12/10/1998

Mary Anna Paquette
Signature

AMERICAN-CANADIAN GENEALOGICAL SOCIETY
4 ELM STREET
MANCHESTER, NH 03108-6478

CONFLICT OF INTEREST POLICY STATEMENT

Any possible conflict of interest on the part of any member of the Board, officer or employee of the Corporation, shall be disclosed in writing to the Board and made a matter of record through an annual procedure and also when the interest involves a specific issue before the Board.

Where the transaction involving a board member, trustee or officer exceeds five hundred dollars (\$500) but is less than five thousand dollars (\$5,000) in a fiscal year, a two-thirds vote of the disinterested directors is required.

Where the transaction involved exceeds five thousand dollars (\$5,000) in a fiscal year, than a two-thirds vote of the disinterested directors and publication in the newspaper is required.

The minutes of the meeting shall reflect that a disclosure was made, the abstention from voting, and the actual vote itself.

Every new member of the Board will be advised of this policy upon entering the duties of his or her office, and shall sign a statement acknowledging, understanding of and agreement to this policy. The Board will comply with all requirements of New Hampshire law in this area and the New Hampshire requirements are incorporated into and made a part of this policy statement.

I, Carol A. Belmain, have read the above policy statement as it relates to Conflict of Interest and understand the contents thereof.

Date:

12/10/98

Carol A. Belmain

Signature

AMERICAN-CANADIAN GENEALOGICAL SOCIETY
4 ELM STREET
MANCHESTER, NH 03108-6478

CONFLICT OF INTEREST POLICY STATEMENT

Any possible conflict of interest on the part of any member of the Board, officer or employee of the Corporation, shall be disclosed in writing to the Board and made a matter of record through an annual procedure and also when the interest involves a specific issue before the Board.

Where the transaction involving a board member, trustee or officer exceeds five hundred dollars (\$500) but is less than five thousand dollars (\$5,000) in a fiscal year, a two-thirds vote of the disinterested directors is required.

Where the transaction involved exceeds five thousand dollars (\$5,000) in a fiscal year, than a two-thirds vote of the disinterested directors and publication in the newspaper is required.

The minutes of the meeting shall reflect that a disclosure was made, the abstention from voting, and the actual vote itself.

Every new member of the Board will be advised of this policy upon entering the duties of his or her office, and shall sign a statement acknowledging, understanding of and agreement to this policy. The Board will comply with all requirements of New Hampshire law in this area and the New Hampshire requirements are incorporated into and made a part of this policy statement.

I, Mary-Jean Colburn Chaput, have read the above policy statement as it relates to Conflict of Interest and understand the contents thereof.

Date:

10 December 1998

Mary-Jean Chaput
Signature

AMERICAN-CANADIAN GENEALOGICAL SOCIETY
4 ELM STREET
MANCHESTER, NH 03108-6478

CONFLICT OF INTEREST POLICY STATEMENT

Any possible conflict of interest on the part of any member of the Board, officer or employee of the Corporation, shall be disclosed in writing to the Board and made a matter of record through an annual procedure and also when the interest involves a specific issue before the Board.

Where the transaction involving a board member, trustee or officer exceeds five hundred dollars (\$500) but is less than five thousand dollars (\$5,000) in a fiscal year, a two-thirds vote of the disinterested directors is required.

Where the transaction involved exceeds five thousand dollars (\$5,000) in a fiscal year, than a two-thirds vote of the disinterested directors and publication in the newspaper is required.

The minutes of the meeting shall reflect that a disclosure was made, the abstention from voting, and the actual vote itself.

Every new member of the Board will be advised of this policy upon entering the duties of his or her office, and shall sign a statement acknowledging, understanding of and agreement to this policy. The Board will comply with all requirements of New Hampshire law in this area and the New Hampshire requirements are incorporated into and made a part of this policy statement.

I, SAMUEL WAYNE HARRIS, have read the above policy statement as it relates to Conflict of Interest and understand the contents thereof.

Date:

12/10/1998

Samuel Wayne Harris
Signature

AMERICAN-CANADIAN GENEALOGICAL SOCIETY
4 ELM STREET
MANCHESTER, NH 03108-6478

CONFLICT OF INTEREST POLICY STATEMENT

Any possible conflict of interest on the part of any member of the Board, officer or employee of the Corporation, shall be disclosed in writing to the Board and made a matter of record through an annual procedure and also when the interest involves a specific issue before the Board.

Where the transaction involving a board member, trustee or officer exceeds five hundred dollars (\$500) but is less than five thousand dollars (\$5,000) in a fiscal year, a two-thirds vote of the disinterested directors is required.

Where the transaction involved exceeds five thousand dollars (\$5,000) in a fiscal year, than a two-thirds vote of the disinterested directors and publication in the newspaper is required.

The minutes of the meeting shall reflect that a disclosure was made, the abstention from voting, and the actual vote itself.

Every new member of the Board will be advised of this policy upon entering the duties of his or her office, and shall sign a statement acknowledging, understanding of and agreement to this policy. The Board will comply with all requirements of New Hampshire law in this area and the New Hampshire requirements are incorporated into and made a part of this policy statement.

I, Pauline R. Labbe, have read the above policy statement as it relates to Conflict of Interest and understand the contents thereof.

Date:

December 10, 1998

Pauline R. Labbe
Signature

AMERICAN-CANADIAN GENEALOGICAL SOCIETY
4 ELM STREET
MANCHESTER, NH 03108-6478

CONFLICT OF INTEREST POLICY STATEMENT

Any possible conflict of interest on the part of any member of the Board, officer or employee of the Corporation, shall be disclosed in writing to the Board and made a matter of record through an annual procedure and also when the interest involves a specific issue before the Board.

Where the transaction involving a board member, trustee or officer exceeds five hundred dollars (\$500) but is less than five thousand dollars (\$5,000) in a fiscal year, a two-thirds vote of the disinterested directors is required.

Where the transaction involved exceeds five thousand dollars (\$5,000) in a fiscal year, than a two-thirds vote of the disinterested directors and publication in the newspaper is required.

The minutes of the meeting shall reflect that a disclosure was made, the abstention from voting, and the actual vote itself.

Every new member of the Board will be advised of this policy upon entering the duties of his or her office, and shall sign a statement acknowledging, understanding of and agreement to this policy. The Board will comply with all requirements of New Hampshire law in this area and the New Hampshire requirements are incorporated into and made a part of this policy statement.

I, Robert Maurier, have read the above policy statement as it relates to Conflict of Interest and understand the contents thereof.

Date:

Dec 10, 1998

Robert Maurier
Signature

AMERICAN-CANADIAN GENEALOGICAL SOCIETY
4 ELM STREET
MANCHESTER, NH 03108-6478

CONFLICT OF INTEREST POLICY STATEMENT

Any possible conflict of interest on the part of any member of the Board, officer or employee of the Corporation, shall be disclosed in writing to the Board and made a matter of record through an annual procedure and also when the interest involves a specific issue before the Board.

Where the transaction involving a board member, trustee or officer exceeds five hundred dollars (\$500) but is less than five thousand dollars (\$5,000) in a fiscal year, a two-thirds vote of the disinterested directors is required.

Where the transaction involved exceeds five thousand dollars (\$5,000) in a fiscal year, than a two-thirds vote of the disinterested directors and publication in the newspaper is required.

The minutes of the meeting shall reflect that a disclosure was made, the abstention from voting, and the actual vote itself.

Every new member of the Board will be advised of this policy upon entering the duties of his or her office, and shall sign a statement acknowledging, understanding of and agreement to this policy. The Board will comply with all requirements of New Hampshire law in this area and the New Hampshire requirements are incorporated into and made a part of this policy statement.

I, Ann Marie Perrault have read the above policy statement as it relates to Conflict of Interest and understand the contents thereof.

Date:

10 Dec 1998

Ann Marie Perrault
Signature

AMERICAN-CANADIAN GENEALOGICAL SOCIETY
4 ELM STREET
MANCHESTER, NH 03108-6478

CONFLICT OF INTEREST POLICY STATEMENT

Any possible conflict of interest on the part of any member of the Board, officer or employee of the Corporation, shall be disclosed in writing to the Board and made a matter of record through an annual procedure and also when the interest involves a specific issue before the Board.

Where the transaction involving a board member, trustee or officer exceeds five hundred dollars (\$500) but is less than five thousand dollars (\$5,000) in a fiscal year, a two-thirds vote of the disinterested directors is required.

Where the transaction involved exceeds five thousand dollars (\$5,000) in a fiscal year, than a two-thirds vote of the disinterested directors and publication in the newspaper is required.

The minutes of the meeting shall reflect that a disclosure was made, the abstention from voting, and the actual vote itself.

Every new member of the Board will be advised of this policy upon entering the duties of his or her office, and shall sign a statement acknowledging, understanding of and agreement to this policy. The Board will comply with all requirements of New Hampshire law in this area and the New Hampshire requirements are incorporated into and made a part of this policy statement.

I, CONSTANCE G. HEBERT, have read the above policy statement as it relates to Conflict of Interest and understand the contents thereof.

Date:

Dec. 10, 1998

Constance G. Hebert
Signature

AMERICAN CANADIAN GENEALOGICAL SOCIETY

BOARD OF DIRECTORS

Name, Title and Position	Address	Telephone/Fax/E-Mail
J Hamel #2513 President	71 Haverhill Road Chester, NH 03036-4207	Home: (603)887-3154; E-mail: hamellot@worldnet.att.net
Roland Marchand #144 Vice President	3 Lorraine Street Hudson NH 03051-4829	home: (603)882-739; E-mail: RAM31@ix.netcom.com
Roger Lawrence #1 Honorary President	67 Lawrence Road Merrimack, NH 03054-2404	home: (603)424-2332; E-Mail: rwmllawrence@aol.com
Gerry Lalonde #3312 Treasurer	PO Box 172 W Nottingham NH 03291-0172	home: (603)942-7448; E-mail: Lalo@worldpath.
Mary Anna Paquette #2378 Corresponding Secretary	PO Box 4146 Manchester NH 03108-4146	home: (603)483-5457; E-mail: mapaquette@grolen.com
Carol A. Belmain #5941 Recording Secretary	PO Box 320 Auburn NH 03032-0320	home: (603)483-8479; E-mail: cbelmain@aol.com; work: 271-2646
Craig S. Donais Director 00	15 Warren Ave., Chelmsford, MA 01824-3008	home: 978-256-8370, cdonais@usa.net
Mary Jean Chaput #3047 Director 00		home: (603)669-0641; (603)629-4173; voice mail: (603)629-4183; E-mail: mcolburn@christa.unh.edu
Charles Martel Director 00	231 Bridge Street, Manchester, NH 03104	Home: (603)647-4527; (603)669-3614
Sam Harris #5996 Director 99	4 Martin Road Fremont NH 03044	home: (603)679-4663; cell: (603)566-7688; E-mail: chrysler@nh.ultranet.com
Pauline Labbe #4261 Director 99	418 Boynton Street Bedford NH 03110-6421	home: (603)622-5493; E-mail: malbalepq@aol.com
Bob Maurier #2068 Director 99	479 Laurel Street Manchester, NH 03103-3429	home: (603)622-3824; work: (603)644-4021
Anne-Marie Perrault #2238 Director 99	131 Danis Park Road Goffstown NH 03045-6601	home: (603)622-1591; fax: (603)626-9812; cell phone/voice mail: (603)493-1676; E-mail: amperrault@aol.com
Constance Hebert #5175 Research 00	313 Elgin Avenue Manchester NH 03104-1435	home: (603)622-4250; E-mail: cl-hebert@worldnet.att.net

AMERICAN-CANADIAN GENEALOGICAL SOCIETY
4 ELM STREET
MANCHESTER, NH 03108-6478

CONFLICT OF INTEREST POLICY STATEMENT

Any possible conflict of interest on the part of any member of the Board, officer or employee of the Corporation, shall be disclosed in writing to the Board and made a matter of record through an annual procedure and also when the interest involves a specific issue before the Board.

Where the transaction involving a board member, trustee or officer exceeds five hundred dollars (\$500) but is less than five thousand dollars (\$5,000) in a fiscal year, a two-thirds vote of the disinterested directors is required.

Where the transaction involved exceeds five thousand dollars (\$5,000) in a fiscal year, than a two-thirds vote of the disinterested directors and publication in the newspaper is required.

The minutes of the meeting shall reflect that a disclosure was made, the abstention from voting, and the actual vote itself.

Every new member of the Board will be advised of this policy upon entering the duties of his or her office, and shall sign a statement acknowledging, understanding of and agreement to this policy. The Board will comply with all requirements of New Hampshire law in this area and the New Hampshire requirements are incorporated into and made a part of this policy statement.

I, ROGER W. LAWRENCE, have read the above policy statement as it relates to Conflict of Interest and understand the contents thereof.

Date:

6 JAN 1999

Roger W. Lawrence
Signature

AMERICAN-CANADIAN GENEALOGICAL SOCIETY
4 ELM STREET
MANCHESTER, NH 03108-6478

CONFLICT OF INTEREST POLICY STATEMENT

Any possible conflict of interest on the part of any member of the Board, officer or employee of the Corporation, shall be disclosed in writing to the Board and made a matter of record through an annual procedure and also when the interest involves a specific issue before the Board.

Where the transaction involving a board member, trustee or officer exceeds five hundred dollars (\$500) but is less than five thousand dollars (\$5,000) in a fiscal year, a two-thirds vote of the disinterested directors is required.

Where the transaction involved exceeds five thousand dollars (\$5,000) in a fiscal year, than a two-thirds vote of the disinterested directors and publication in the newspaper is required.

The minutes of the meeting shall reflect that a disclosure was made, the abstention from voting, and the actual vote itself.

Every new member of the Board will be advised of this policy upon entering the duties of his or her office, and shall sign a statement acknowledging, understanding of and agreement to this policy. The Board will comply with all requirements of New Hampshire law in this area and the New Hampshire requirements are incorporated into and made a part of this policy statement.

I, _____, have read the above policy statement as it relates to Conflict of Interest and understand the contents thereof.

Date: _____ Signature _____

[Paragraph II effective until January 1, 1998]

II. "Charitable trust" means any fiduciary relationship with respect to property arising as a result of a manifestation of an intention to create it and subjecting the person by whom the property is held to equitable duties to deal with the property for charitable or community purposes.

[Paragraph II effective January 1, 1998]

II. (a) "Charitable trust" means any fiduciary relationship with respect to property arising under the law of this state or of another jurisdiction as a result of a manifestation of intention to create it, and subjecting the person by whom the property is held to fiduciary duties to deal with the property within this state for any charitable, nonprofit, educational, or community purpose. Charitable trust includes, but is not limited to "charitable organization," as that term is defined in subparagraph (b). The fact that any person or entity sought to be charged with fiduciary duties is a corporation, association, foundation, or any other type of organization that, under judicial decisions or other statutes, has not been recognized as, or has been distinguished from, a charitable trust does not provide a presumption against its being a charitable trust as defined in this paragraph.

(b) "Charitable organization" means the following:

(1) Any person or entity that is determined by the Internal Revenue Service to be a tax exempt organization pursuant to section 501(c) (3) of the Internal Revenue Code, as that section now exists or may hereafter be amended; or

(2) Any other person or entity that is or holds itself out to be established, in whole or in part, for any benevolent, philanthropic, patriotic, educational, humane, scientific, public health, environmental conservation, civic, or other charitable purpose or any person who in any manner employs a charitable appeal as the basis of any solicitation or an appeal that suggests that there is a charitable purpose to any solicitation. "Charitable organization" is not limited to those organizations to which contributions are tax deductible under section 170 of the Internal Revenue Code.

III. "Commercial co-venturer" means a person who for profit is regularly and primarily engaged in trade or commerce other than in connection with soliciting for charitable trusts or purposes and who conducts a charitable sales promotion.

IV. "Contribution" means the grant, promise, or pledge of money, credit, property, financial assistance, or other thing of any kind or value in response to a solicitation. It does not include bona fide fees, dues or assessments paid by members, provided that membership is not conferred solely as consideration for making a contribution in response to a solicitation.

V. "Fund raising counsel" means a person who for compensation plans, manages, advises, consults, or prepares material for, or with respect to, the solicitation in this state of contributions for a charitable trust, but who does not solicit contributions and who does not employ, procure,